

Permanently Securing the Qtrac[®] Remotes

Required:  Two #6 Wood Screws per Remote (not included)

STEP 1:

Determine the position for the Remote Control.

Allow enough space for the Remote, considering that the Screw placement/attachment occurs at the top of the back of the Remote.

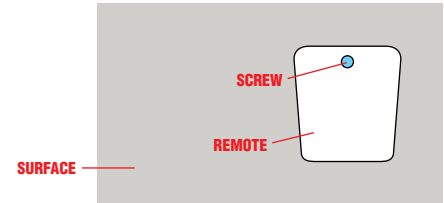

STEP 2:

Mount one #6 Wood Screw (1/2" recommended) into the hard surface.

Do not screw all the way down. Leave space between the screw head and the surface.

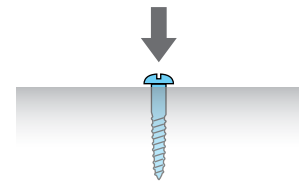

STEP 3:

Mount the Remote Control.

On the back of the Remote, there is an opening that looks like . Position the larger portion of the opening directly over the head of the screw, flush to the surface and slide the remote down until the head of the screw catches in the smaller portion of the opening.

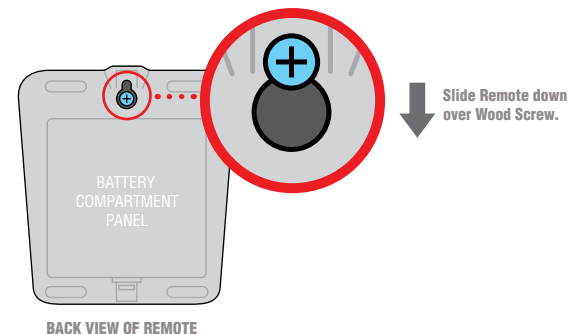

STEP 4:

Secure the Remote Control with the second #6 Wood Screw.

To prevent the Remote from slipping forward and off the first Wood Screw, secure the second Wood Screw into the mounting surface at the top base of the Remote to hold it in place.

