



Lavi Industries
Architectural Railing and Fittings



Brass and 304 Stainless Steel
Fittings, Tubing and Extrusion

Summer 2020

Handrail Brackets

Solid Brass and Stainless Steel Components

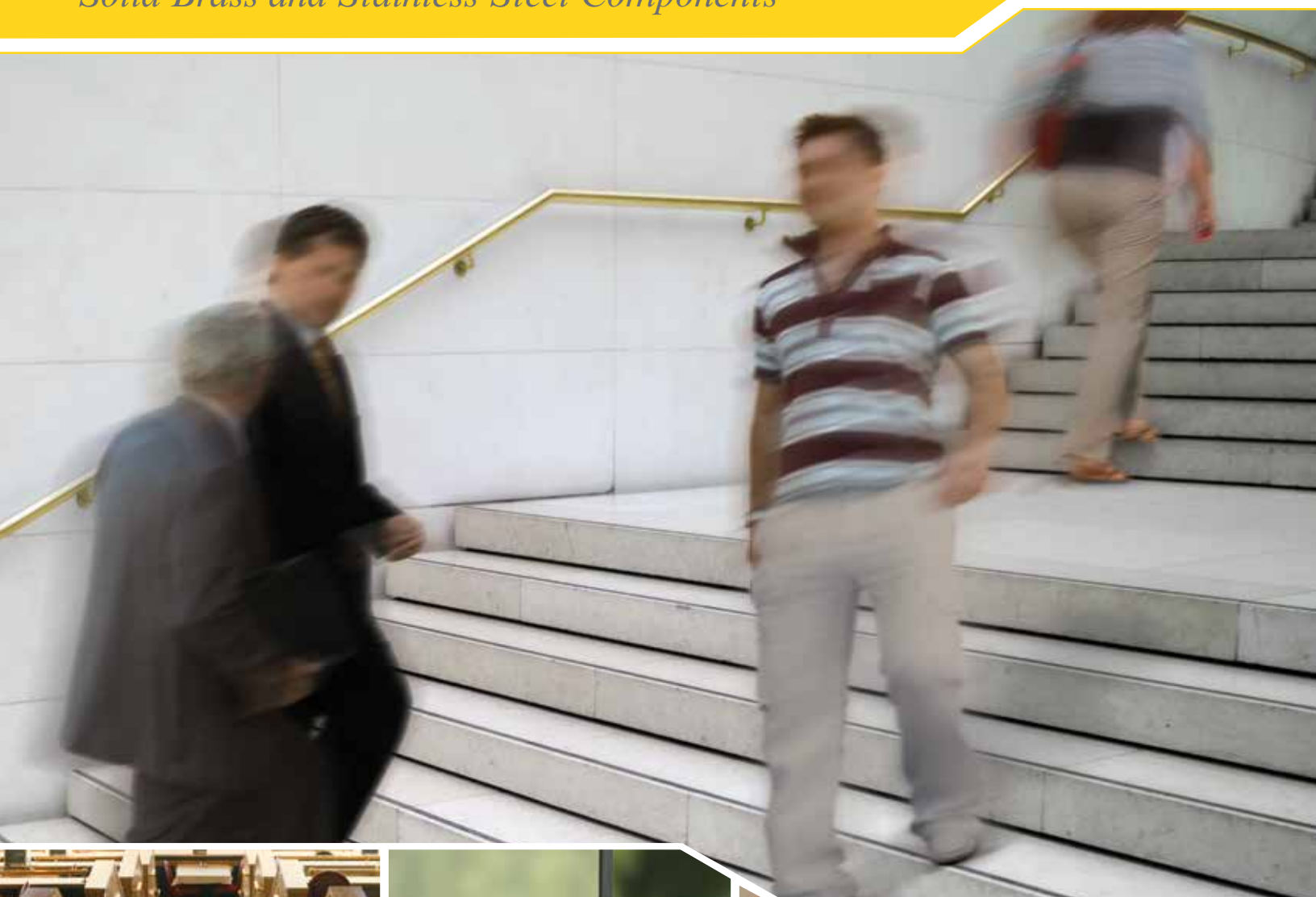

Constructed of heavy-duty materials, our brackets offer strong and durable railing support.

Handrail Brackets

Solid Brass and Stainless Steel Components

Standard Finishes & Materials: Polished Brass, Polished Stainless Steel & Satin Stainless Steel.
In addition to our standard finishes, Brass Clear Coat & Lido Tone finishes may be available. Please call for details.

	BRASS
	STAINLESS STEEL
	BRASS & STAINLESS STEEL

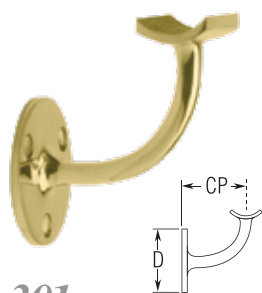

301
Standard Handrail Bracket

Item#	Tubing	CP	D
● 301/1H	1 ½"	2 ½"	2 ½"
● 301/2	2"	2 ¾"	2 ½"

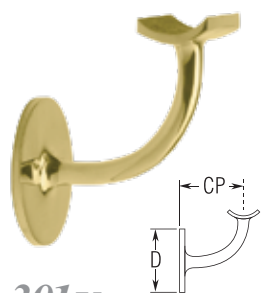

301U
Undrilled Handrail Bracket

Item#	Tubing	CP	D
● 301U/1H	1 ½"	2 ½"	2 ½"
● 301U/2	2"	2 ¾"	2 ½"

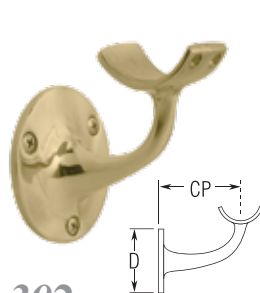

302
Deluxe Handrail Bracket

Item#	Tubing	CP	D
● 302/2	2"	2 ¾"	3 ⅞"

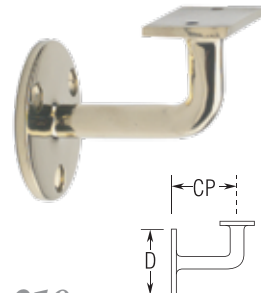

310
Flat Rail Bracket

Item#	Tubing	CP	D
● 310	Sq.	2 ½"	2 ⅜"



304
Glass Mount Rail Bracket

Item#	Tubing	CP	D
● 304/1H	1 ½"	2 ⅝"	2 ½"
● 304/2	2"	2 ⅝"	2 ½"



Related Products



Wall Return
608

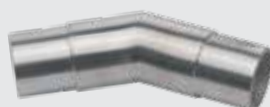

Flush 147° Angle
730A



Lavi Metal Polish
00202



Loctite 326 Adhesive
Recommended for Brass!
00201



Loctite 7649 Primer
Recommended for
Stainless Steel!
00211

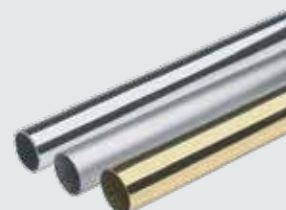

Tubing

Please check our current price list for ongoing information updates.

Lavi Industries

877.ASK.LAVI | railings@lavi.com | www.railings.lavi.com

© 2019 Lavi Industries All rights reserved. All product design is the property of Lavi Industries.
SPEC-RF-0110-0119

Handrail Brackets

Interchangeable Stainless Steel Component Series



An innovative system that allows you to customize a variety of handrail and short rail projects.

Handrail Brackets

Interchangeable Stainless Steel Component Series

Custom and special orders available. Please call for quote.

These components are
only available in
316 Stainless Steel



348

Low Saddle Post

Item#	Tubing	CP	D
348/1H	1 1/2"	3 7/8"	3"
348/2	2"	3 7/8"	3"



348U

Undrilled Low Saddle Post

Item#	Tubing	CP	D
348U/1H	1 1/2"	3 7/8"	3"
348U/2	2"	3 7/8"	3"



348L

Tall Saddle Post

Item#	Tubing	CP	D
348L/1H	1 1/2"	6 1/8"	3"
348L/2	2"	6 1/4"	3"



348LIU

Undrilled Tall Saddle Post

Item#	Tubing	CP	D
348L/U/1H	1 1/2"	6 1/8"	3"
348L/U/2	2"	6 1/4"	3"



308

Handrail Bracket

Item#	Tubing	CP	D
308/1H	1 1/2"	3"	3"
308/2	2"	3"	3"



308U

Undrilled Handrail Bracket

Item#	Tubing	CP	D
308U/1H	1 1/2"	3"	3"
308U/2	2"	3"	3"



308GM

Glass Mount Rail Bracket

Item#	Tubing	CP	D
308GM/1H	1 1/2"	2 7/8"	3"
308GM/2	2"	2 7/8"	3"

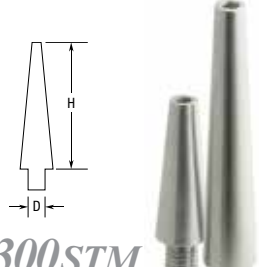

300STM

Bracket Stem

Item#	Height	D
300STM	2.25"	.63"
300STM/L	4.34"	.63"

Hardware sold separately.



300HS

Handrail Saddle

Item#	Tubing
300HS/1H	1 1/2"
300HS/2	2"

Hardware sold separately.



300PS

Post Saddle

Item#	Tubing
300PS/1H	1 1/2"
300PS/2	2"

Hardware sold separately.



300P

Bracket Mounting Plate

Item#	Diameter
300P	3"

Hardware sold separately.



300PIU

Undrilled Bracket Mounting Plate

Item#	Diameter
300P/U	3"

Hardware sold separately.



300GP

Glass Mount Back Plate

Item#	Diameter
300GP	3"

Hardware sold separately.

Brass & Stainless Steel Tubing

Item#	Dia.	Thickness
A100	1"	.050
A110	1 1/2"	.050
A120	2"	.050

Available in all finishes.



Please check our current price list for ongoing information updates.

Cap Rail Components

Solid Brass Components

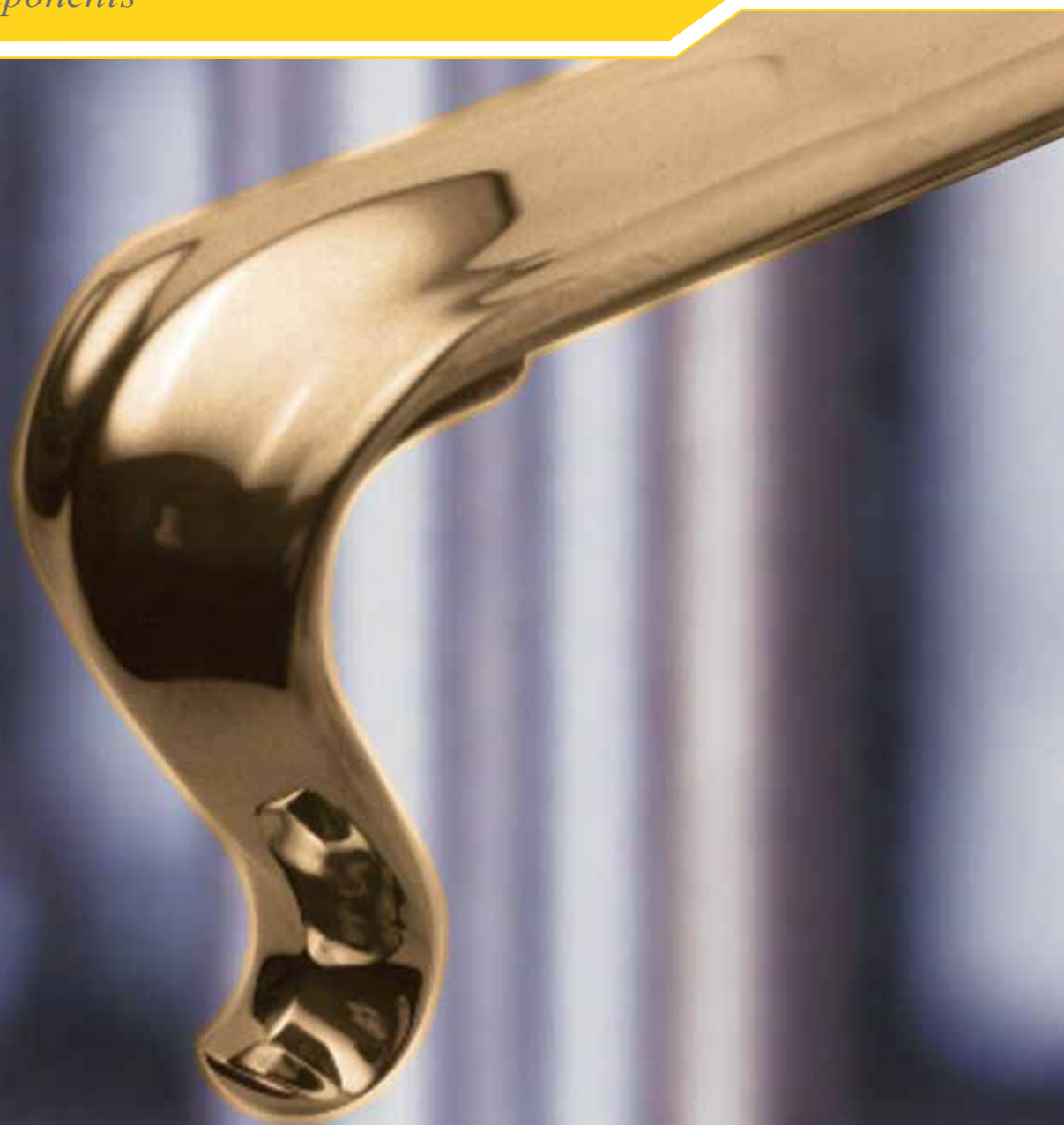

*Solid brass components add elegance
to commercial and residential projects.*

Cap Rail Components

Solid Brass Components

Standard Finishes & Materials: Polished Brass, Polished Stainless Steel, & Satin Stainless Steel.

In addition to our standard finishes, Brass Clear Coat & Lido Tone finishes may be available. Please call for details.

	BRASS
	STAINLESS STEEL
	BRASS & STAINLESS STEEL

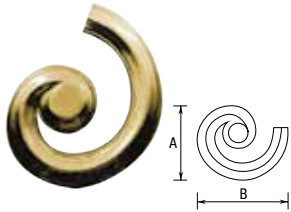

H1600SL

Lateral Scroll (left)

Item#	A	B
● H1600SL	9"	11 1/8"

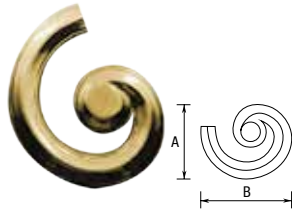

H1600SR

Lateral Scroll (right)

Item#	A	B
● H1600SR	9"	11 1/8"

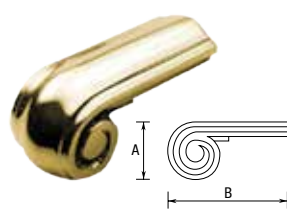

H1600SE

Cap Rail Scroll End

Item#	A	B
● H1600SE	2 1/2"	5 1/4"

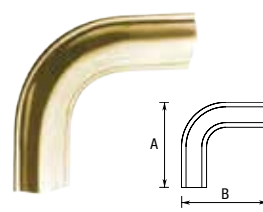

H1600CB

Cap Rail Corner Bend

Item#	A	B
● H1600CB	5 3/4"	5 3/4"

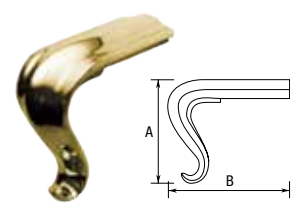

H1600LT

Cap Rail Lamb Tongue End

Item#	A	B
● H1600LT	4 1/2"	5 1/4"

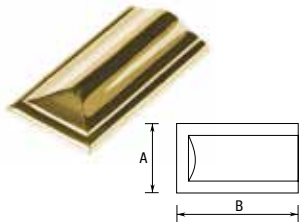

H1600E

Cap Rail Square End

Item#	A	B
● H1600E	2"	3 5/8"

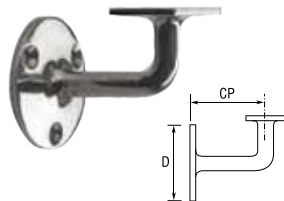

310

Flat Rail Bracket

Item#	CP	D
● 310	2 1/2"	2 1/4"

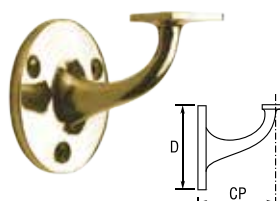

311

Deluxe Flat Rail Bracket

Item#	CP	D
● 311	3"	3 1/4"

Rail Installation

Please check our current price list for ongoing information updates.

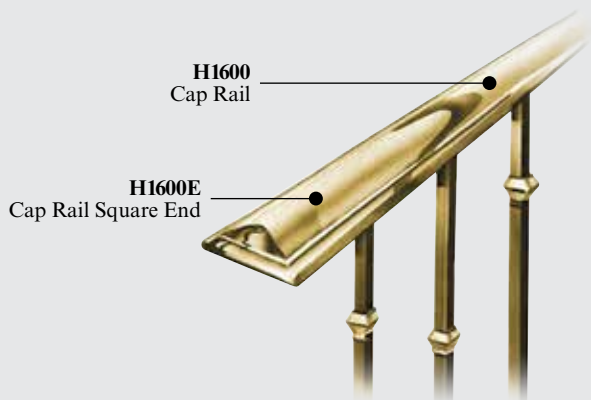

Cap Rail Extrusions

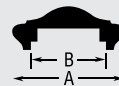

Item#	A	B	Mill Length
● H1600	2"	1 5/16"	16 ft. / 20 ft.
● H1800	2 1/4"	1 9/16"	16 ft.

Short Rail Posts

Solid Brass and Stainless Steel Components



Short Rail Posts are the perfect choice for short walls, curtain rods, door pulls, and much more!

Short Rail Posts

Solid Brass and Stainless Steel Components

Standard Finishes & Materials: Polished Brass, Polished Stainless Steel, & Satin Stainless Steel.
In addition to our standard finishes, Brass Clear Coat & Lido Tone finishes may be available. Please call for details.

	BRASS
	STAINLESS STEEL
	BRASS & STAINLESS STEEL

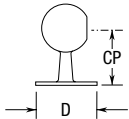

330

Ball End Post

Item#	Tubing	CP	D
● 330/1	1"	2 3/4"	2 1/4"
● 330/1H	1 1/2"	2 3/4"	2 15/16"
● 330/2	2"	3"	3 3/8"

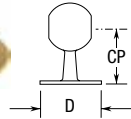

332

Ball Center Post

Item#	Tubing	CP	D
● 332/1	1"	2 3/4"	2 1/4"
● 332/1H	1 1/2"	2 3/4"	2 15/16"
● 332/2	2"	3"	3 3/8"

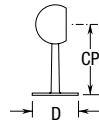

334

6" Ball End Post

Item#	Tubing	CP	D
● 334/2	2"	5"	3 1/4"

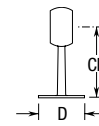

336

6" Ball Center Post

Item#	Tubing	CP	D
● 336/2	2"	5"	3 1/4"

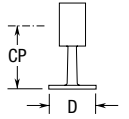

340

Flush End Post

Item#	Tubing	CP	D
● 340/1	1"	2 1/8"	1 3/4"
● 340/1H	1 1/2"	2 7/16"	2 5/16"
● 340/2	2"	3 1/4"	2 1/2"

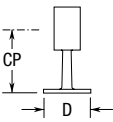

342

Flush Center Post

Item#	Tubing	CP	D
● 342/1	1"	2 1/8"	1 3/4"
● 342/1H	1 1/2"	2 7/16"	2 5/16"
● 342/2	2"	3 1/4"	2 1/2"

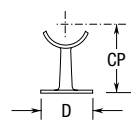

341

Saddle Post

Item#	Tubing	CP	D
● 341/1H	1 1/2"	2 1/2"	2 1/4"
● 341/2	2"	3 1/4"	2 1/2"

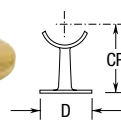

341U

Undrilled Saddle Post

Item#	Tubing	CP	D
● 341U/1H	1 1/2"	2 1/2"	2 1/4"
● 341U/2	2"	3 1/4"	2 1/2"

Related Products

Please check our current price list for ongoing information updates.



Flush End Cap
600



Flush Ell
732



Lavi Metal Polish
00202



Loctite 326 Adhesive
Recommended for Brass!
00201



Loctite 7649 Primer
Recommended for
Stainless Steel!
00211

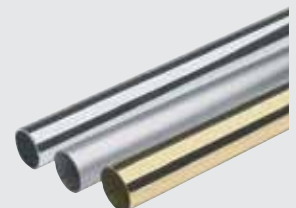

Tubing

Lavi Industries

877.ASK.LAVI | railings@lavi.com | www.railings.lavi.com

© 2019 Lavi Industries All rights reserved.
All product design is the property of Lavi Industries.
SPEC-RF-0114-0314

Brackets for Footrail & Armrail

Solid Brass and Stainless Steel Components



Lavi's full line of foot rail and arm rail fittings enhance both traditional and contemporary railing projects.

Brackets for Footrail & Armrail

Solid Brass and Stainless Steel Components

Standard Finishes & Materials: Polished Brass, Polished Stainless Steel, & Satin Stainless Steel.

In addition to our standard finishes, Brass Clear Coat & Lido Tone finishes may be available. Please call for details.



400

Combination Bracket

Item#	Tubing	CP	H
400/1H	1 1/2"	6 7/16"	6 5/8"
400/2	2"	6 1/8"	7"



400

Combination Bracket

Item#	Tubing	CP	H
400/1H	1 1/2"	6 1/4"	6 7/32"
400/2	2"	5 15/16"	6 15/16"



402

Bar Mount Bracket

Item#	Tubing	CP	B
402/1H	1 1/2"	6 1/16"	4"
402/2	2"	6 7/8"	4 1/4"

Bar Mount Bracket may be bolted from back side for additional strength.

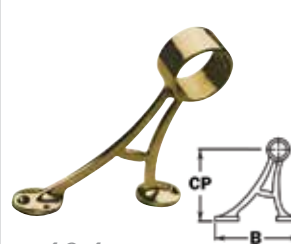

404

Floor Mount Bracket

Item#	Tubing	CP	B
404/1H	1 1/2"	6"	6 5/16"
404/2	2"	6 1/8"	6 11/16"

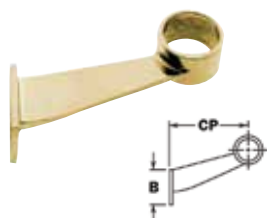

406

Contemporary Bracket

Item#	Tubing	CP	B
406/2	2"	6 1/16"	2 7/8"

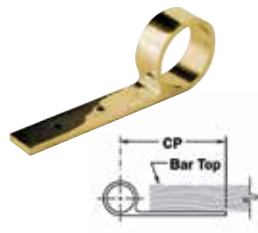

450

Armrail Bracket

Item#	Tubing	CP
450/1H	1 1/2"	5 3/4"
450/2	2"	5 9/16"

Brass & Stainless Steel Tubing

Item#	Dia.	Thickness
A100	1"	.050
A110	1 1/2"	.050
A120	2"	.050

Available in all finishes.

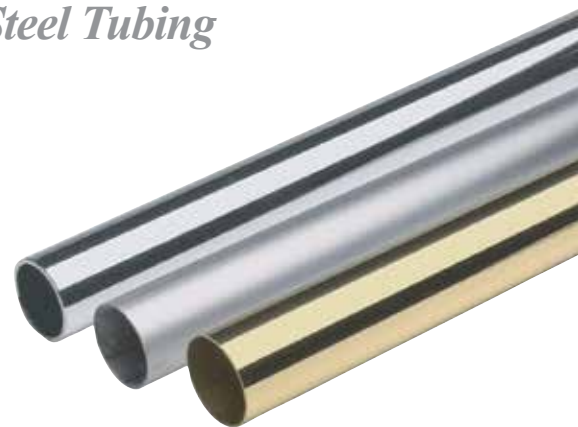

Related Products

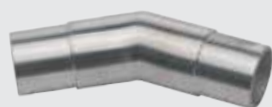

Flush 147° Angle
730A



Ball Finial
604

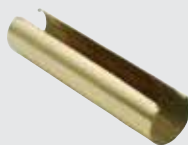

Splice
830



Lavi Metal Polish
00202



Loctite 326 Adhesive
Recommended for Brass!
00201



Loctite 7649 Primer
Recommended for
Stainless Steel!
00211

Please check our current price list for ongoing information updates.

Lavi Industries

877.ASK.LAVI | railings@lavi.com | www.railings.lavi.com

© 2019 Lavi Industries All rights reserved.
All product design is the property of Lavi Industries.
SPEC-RF-0108-0314

Flanges

Solid Brass and Stainless Steel Components



Wall and floor flanges for almost any mounting condition.

Flanges

Solid Brass and Stainless Steel Components

Standard Finishes & Materials: Polished Brass, Polished Stainless Steel, & Satin Stainless Steel.

In addition to our standard finishes, Brass Clear Coat & Lido Tone finishes may be available. Please call for details.

	BRASS
	STAINLESS STEEL
	BRASS & STAINLESS STEEL



500
2" Wall Flange

Item#	Tubing	D	H
● 500/1	1"	2"	7/8"



500U
Undrilled 2" Wall Flange

Item#	Tubing	D	H
● 500U/1	1"	2"	7/8"



510
3" Wall Flange

Item#	Tubing	D	H
● 510/1H	1 1/2"	3"	1 1/4"



510U
Undrilled 3" Wall Flange

Item#	Tubing	D	H
● 510U/1H	1 1/2"	3"	1 1/4"



511/531
Cut Wall Flange

Item#	Tubing	D	W
● 511/1H	1 1/2"	3"	2"
● 531/2	2"	4"	2 1/2"



512
4" Floor Flange

Item#	Tubing	D	H
● 512/1H	1 1/2"	4"	1 1/4"



530
4" & 5 1/2" Wall Flanges

Item#	Tubing	D	H
● 530/2	2"	4"	1 1/4"



532
5" Floor Flange

Item#	Tubing	D	H
● 532/2	2"	5"	1 3/8"



590
Flange for Square Tubing

Item#	Tubing	W	H
● 590/1H	1 1/2"	3 1/2"	1 1/2"
● 590/2	2"	4"	1 1/2"



591
Cut Flange for Square Tubing

Item#	Tubing	W	L
● 591/1H	1 1/2"	3 1/2"	2 1/2"
● 591/2	2"	4"	3 1/4"

Brass & Stainless Steel Tubing

Item#	Dia.	Thickness
A100	1"	.050
A110	1 1/2"	.050
A120	2"	.050

Available in all finishes.

Polished Stainless Steel	40	10	Polished Chrome
Polished Brass	00	02	Satin Stainless Steel
			Clear Coat Brass



Please check our current price list for ongoing information updates.

End Caps & Finials

Solid Brass and Stainless Steel Components

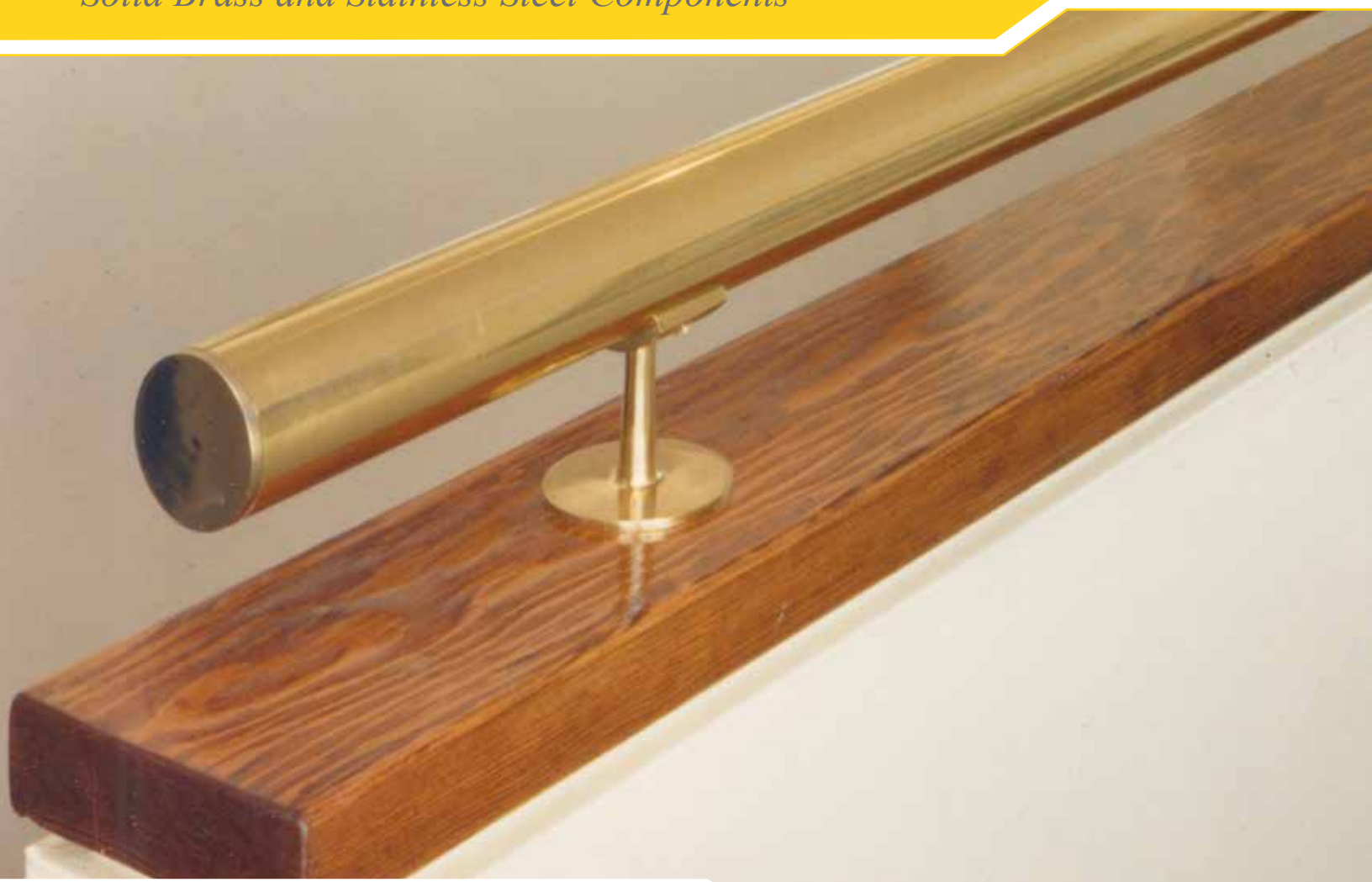

Solid brass and stainless steel fittings offer numerous ways to finish off your project.

End Caps & Finials

Solid Brass and Stainless Steel Components

Standard Finishes & Materials: Polished Brass, Polished Stainless Steel, & Satin Stainless Steel.

In addition to our standard finishes, Brass Clear Coat & Lido Tone finishes may be available. Please call for details.

	BRASS
	STAINLESS STEEL
	BRASS & STAINLESS STEEL

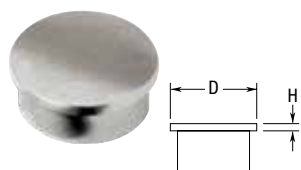

600

Flush End Cap

Item#	Tubing	D	H
600/1	1"	1"	1/8"
600/1H	1 1/2"	1 1/2"	1/8"
600/2	2"	2"	1/8"

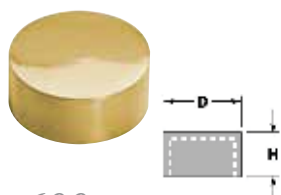

600W

Flush End Cap for Wood

Item#	Tubing	D	H
600W/2	2"	2 1/8"	7/8"

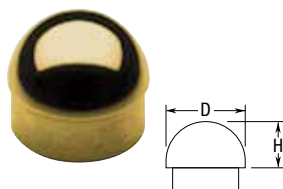

602

Half Ball/Rounded End Cap

Item#	Tubing	D	H
602/1	1"	1"	1/2"
602/1H	1 1/2"	1 1/2"	3/4"
602/2	2"	2"	1"



604

Ball Finial

Item#	Tubing	D	H
604/1	1"	1 1/2"	2"
604/1H	1 1/2"	2 3/8"	3 1/4"
604/2	2"	3 1/8"	4 1/2"
604/2	2"	3 3/16"	4 5/8"

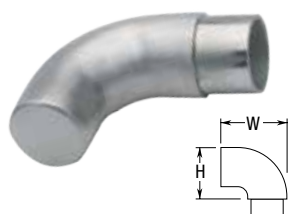

608

Radius Wall Return

Item#	Tubing	W	H
608/1H	1 1/2"	3"	2 3/4"
608/2	2"	3 1/4"	3"

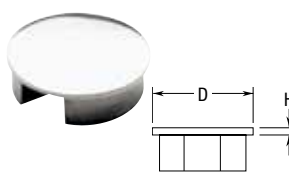

640

Channel Tube End Cap

Item#	Tubing	D	H
640/1H	1 1/2"	1 1/2"	1/8"
640/2	2"	2"	1/8"

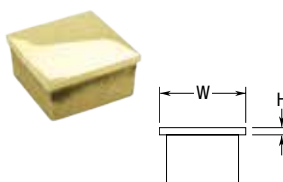

650

Flat Square End Cap

Item#	Tubing	W	H
650/1H	1 1/2"	1 1/2"	1/8"
650/2	2"	2"	1/4"



606

Scroll Finial

Item#	Tubing	D	H
606/1H	1 1/2"	2 3/4"	2 7/8"
606/2	2"	3 1/4"	2 1/2"

Related Products

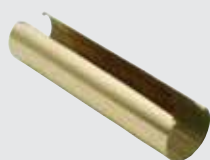

Splice
830



Lavi Metal Polish
00202



Loctite 326 Adhesive
Recommended for Brass!
00201



Loctite 7649 Primer
Recommended for
Stainless Steel!
00211

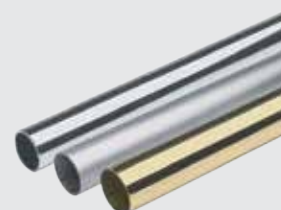

Tubing

Lavi Industries

877.ASK.LAVI | railings@lavi.com | www.railings.lavi.com

Please check our current price list for ongoing information updates.

Universal Connectors

Solid Brass and Stainless Steel Components



*Custom angles are easy to achieve
with our wide selection of Universal
and Adjustable Connectors.*

Universal Connectors

Solid Brass and Stainless Steel Components

Standard Finishes & Materials: Polished Brass, Polished Stainless Steel, & Satin Stainless Steel.
In addition to our standard finishes, Brass Clear Coat & Lido Tone finishes may be available. Please call for details.

	BRASS
	STAINLESS STEEL
	BRASS & STAINLESS STEEL



800
Angle Collar

Item#	Tubing	D	H
800/1H	1 1/2"	1 3/4"	1 5/16"
800/2	2"	2 3/16"	1"



801
Flush Angle Collar

Item#	Tubing	D	H
801/2	2"	2"	7/8"



806
1" Picket Connector

Item#	D1	D2	H
806/1	1"	2"	1 3/4"



818
Perpendicular Collar

Item#	Tubing	D	H
818/1	1"	1"	1 5/8"
818/1H	1 1/2"	1 1/2"	1 15/16"
818/2	2"	2"	2"

No installation hardware supplied.
Mounting hole has clearance for 1/4" fastener.



818CP
Coped Perpendicular Collar

Item#	Tubing	D	H
818CP/2	2"	3 1/2"	1 5/16"

No installation hardware supplied.
Mounting hole has clearance for 1/4" fastener.



819
Outer Perpendicular Collar

Item#	Tubing	D	H
819/2	2"	2 3/16"	1 3/4"

No installation hardware supplied.
Mounting hole has clearance for 1/4" fastener.



820
Adjustable Saddle

Item#	Tubing	D	CP
820/1H	1 1/2"	1 1/2"	2 7/8"
820/2	2"	2"	3 1/8"



821
Ball Adjustable Saddle

Item#	Tubing	D	CP
821/1H	1 1/2"	2"	3 5/8"
821/2	2"	2"	2 7/8"



822
Adjustable Tee

Item#	Tubing	D	CP
822/2	2"	2"	3"



732A
Adjustable Flush Elbow

Item#	Tubing	D	CP
732A/1H	1 1/2"	1 1/2"	1 3/4"

Related Products

Please check our current price list for ongoing information updates.



Ball Ell
702



Flush Radius Ell
731



Mounting Flange & Canopy
542SET



Loctite 326 Adhesive
Recommended for Brass!
00201



Loctite 7649 Primer
Recommended for
Stainless Steel!
00211

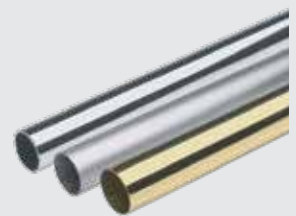

Tubing

Lavi Industries

877.ASK.LAVI | railings@lavi.com | www.railings.lavi.com

© 2019 Lavi Industries. All rights reserved.
All product design is the property of Lavi Industries.
SPEC-RF-0104-0119

Ball Fittings

Solid Brass and Stainless Steel Components



A great choice for traditional railing projects.

Vertical posts should be made with continuous tubing (for strength) while horizontals can be cut to fit between posts.

Ball Fittings

Solid Brass and Stainless Steel Components

Standard Finishes & Materials: Polished Brass, Polished Stainless Steel, & Satin Stainless Steel.

In addition to our standard finishes, Brass Clear Coat & Lido Tone finishes may be available. Please call for details.



700
Ball Single Outlet

Item#	Tubing	D	L
700/1H	1 1/2"	2 1/2"	2 3/4"
700/2	2"	3 1/4"	3 3/8"



701
Ball Parallel Outlet

Item#	Tubing	D	L
701/1H	1 1/2"	2 1/2"	2 7/8"
701/2	2"	3 1/4"	3 3/8"



701A
135° Ball Ell

Item#	Tubing	D	L
701A/1H	1 1/2"	3 1/4"	2 1/2"
701A/2	2"	5"	3 1/4"



708
Ball 135° Side Outlet Ell

Item#	Tubing	D	L
708/1H	1 1/2"	3 1/4"	2 1/2"
708/2	2"	4"	3 1/4"



709
Ball 135° Side Outlet Tee

Item#	Tubing	D	L
709/1H	1 1/2"	3 1/4"	2 1/2"
709/2	2"	4"	3 1/4"



702
Ball Ell

Item#	Tubing	D	L
702/1	1"	2"	2 1/2"
702/1H	1 1/2"	2 1/2"	2 3/4"
702/2	2"	3 1/4"	3 3/8"



703
Ball Side Outlet Ell

Item#	Tubing	D	L
703/1	1"	2"	2 1/2"
703/1H	1 1/2"	2 1/2"	2 3/4"
703/2	2"	3 1/4"	3 3/8"



704
Ball Tee

Item#	Tubing	D	L
704/1	1"	2"	2 1/2"
704/1H	1 1/2"	2 1/2"	2 3/4"
704/2	2"	3 1/4"	3 3/8"



705
Ball Side Outlet Tee

Item#	Tubing	D	L
705/1	1"	2"	2 1/2"
705/1H	1 1/2"	2 1/2"	2 3/4"
705/2	2"	3 1/4"	3 3/8"



706
Ball Cross

Item#	Tubing	D	L
706/1H	1 1/2"	2 1/2"	3"
706/2	2"	3"	3 1/2"



707
Ball Side Outlet Cross

Item#	Tubing	D	L
707/1H	1 1/2"	2 1/2"	2 3/4"
707/2	2"	3 1/4"	3 3/8"



800
Angle Collar

Item#	Tubing	D	H
800/1H	1 1/2"	1 3/4"	15/16"
800/2	2"	2 3/16"	1"



801
Flush Angle Collar

Item#	Tubing	D	H
801/2	2"	2"	7/8"

Brass & Stainless Steel Tubing

Item#	Dia.	Thickness
A100	1"	.050
A110	1 1/2"	.050
A120	2"	.050

Available in all finishes.



Please check our current price list for ongoing information updates.

Flush Fittings

Solid Brass and Stainless Steel Components

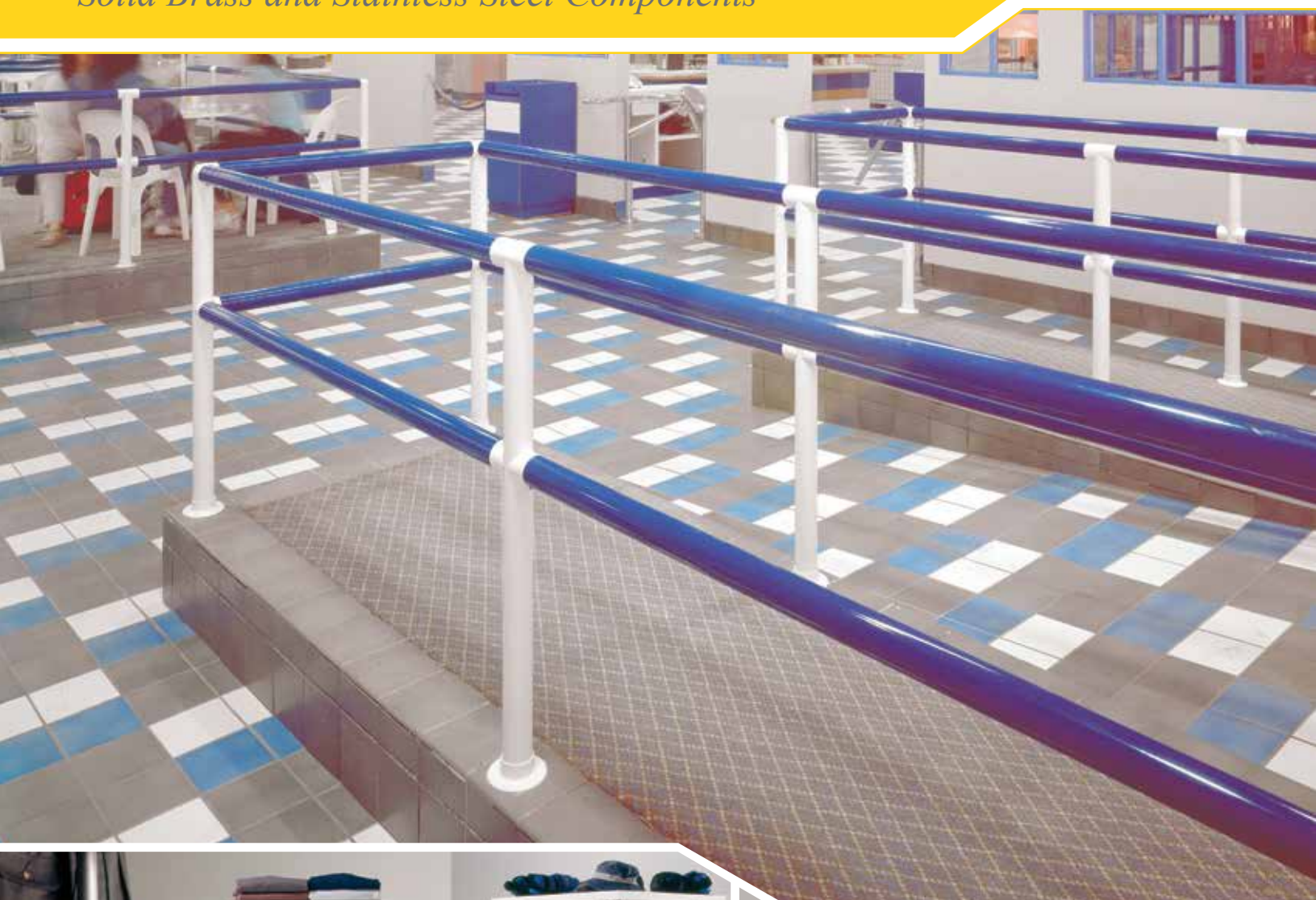

The contemporary look of flush fittings enhance any railing project.

Our flush fittings feature a 1" long sleeve (the longest in the industry) for added strength and adhesive coverage.

Flush Fittings

Solid Brass and Stainless Steel Components

Standard Finishes & Materials: Polished Brass, Polished Stainless Steel, & Satin Stainless Steel.

In addition to our standard finishes, Brass Clear Coat & Lido Tone finishes may be available. Please call for details.

	BRASS
	STAINLESS STEEL
	BRASS & STAINLESS STEEL

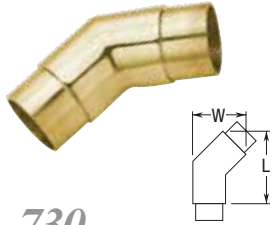

730

Flush 135° Angle

Item#	Tubing	W	L
● 730/1H	1 1/2"	2 15/16"	3"
● 730/2	2"	2 7/8"	3 3/8"



730A

Flush 147° Angle

Item#	Tubing	W	L
● 730A/1H	1 1/2"	2 1/4"	3 1/4"
● 730A/2	2"	2 3/4"	3 3/4"



731

Flush Radius Ell

Item#	Tubing	W	L
● 731/1	1"	1 7/8"	1 7/8"
● 731/1H	1 1/2"	2 7/8"	2 7/8"
● 731/2	2"	3"	3"



732

Flush Ell

Item#	Tubing	W	L
● 732/1H	1 1/2"	2 1/4"	2 1/4"
● 732/2	2"	2 1/2"	2 1/2"



733

Flush Side Outlet Ell

Item#	Tubing	W	L
● 733/1H	1 1/2"	2 1/4"	2 1/4"
● 733/2	2"	2 1/2"	2 1/2"



734

Flush Tee

Item#	Tubing	W	L
● 734/1H	1 1/2"	3"	2 1/4"
● 734/2	2"	3"	2 1/2"

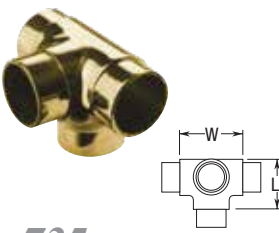

735

Flush Side Outlet Tee

Item#	Tubing	W	L
● 735/1H	1 1/2"	3"	2 1/4"
● 735/2	2"	3"	2 1/2"

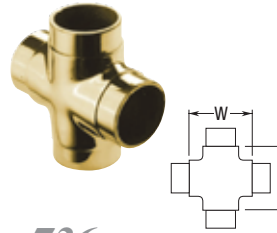

736

Flush Cross

Item#	Tubing	W	L
● 736/1H	1 1/2"	3"	3"
● 736/2	2"	3"	3"



738

Flush 135° Side Outlet Ell

Item#	Tubing	W	CP
● 738/1H	1 1/2"	2 1/4"	1 3/4"
● 738/2	2"	2 7/8"	2"

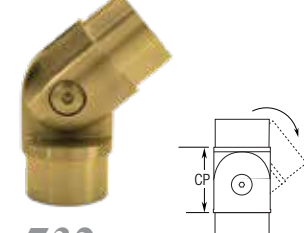

732A

Adjustable Flush Elbow

Item#	Tubing	D	CP
● 732A/1H	1 1/2"	1 1/2"	1 3/4"



818

Perpendicular Collar

Item#	Tubing	D	H
● 818/1	1"	1"	1 5/8"
● 818/1H	1 1/2"	1 1/2"	1 15/16"
● 818/2	2"	2"	2"

No installation hardware supplied.

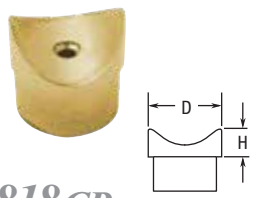

818CP

Coped Perpendicular Collar

Item#	Tubing	D	H
● 818CP/2	2"	3 1/2"	1 15/16"

No installation hardware supplied.

Brass & Stainless Steel Tubing

Item#	Dia.	Thickness
A100	1"	.050
A110	1 1/2"	.050
A120	2"	.050

Available in the following finishes:

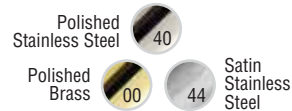

Please check our current price list for ongoing information updates.

Lavi Industries

877.ASK.LAVI | railings@lavi.com | www.railings.lavi.com

© 2019 Lavi Industries. All rights reserved.
All product design is the property of Lavi Industries.
SPEC-RF-0107-0314

Pre-Fab Ball Posts

Factory-assembled posts arrive ready for installation

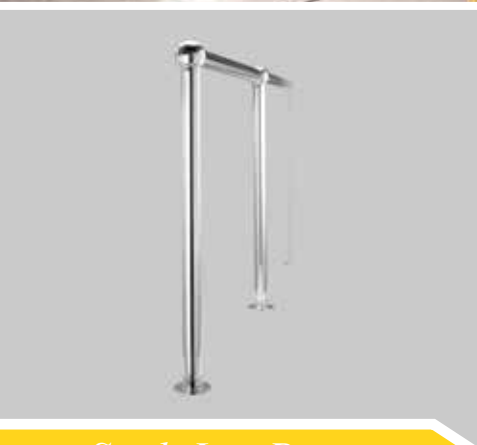

Single Line Posts



Double Line Posts



Low Line Posts



- Prefabricated for quick and easy installation
- Factory welded posts provide for greater strength
- Space posts no greater than 4 feet apart for maximum stability

Pre-Fab Ball Posts

Factory-assembled posts arrive ready for installation

Custom and special orders available. Please call for quote.

Polished
Stainless Steel

40

44

Satin
Stainless Steel

SINGLE LINE BALL POSTS

End Post

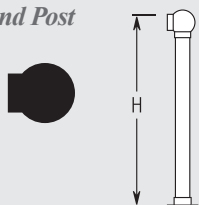

Item#	Tubing	Height
S102/3	1 1/2"	36"
S202/3	2"	36"
S202/4	2"	42"

Corner Post

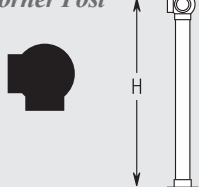

Item#	Tubing	Height
S103/3	1 1/2"	36"
S203/3	2"	36"
S203/4	2"	42"

Center Post

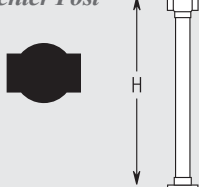

Item#	Tubing	Height
S104/3	1 1/2"	36"
S204/3	2"	36"
S204/4	2"	42"

Tee Post

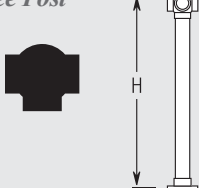

Item#	Tubing	Height
S105/3	1 1/2"	36"
S205/3	2"	36"
S205/4	2"	42"

135° Corner Post

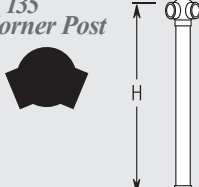

Item#	Tubing	Height
S108/3	1 1/2"	36"
S208/3	2"	36"
S208/4	2"	42"

DOUBLE LINE BALL POSTS

End Post

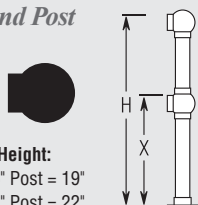

X Height:
36" Post = 19"
42" Post = 22"

Item#	Tubing	Height
D102/3	1 1/2"	36"
D202/3	2"	36"
D202/4	2"	42"

Corner Post

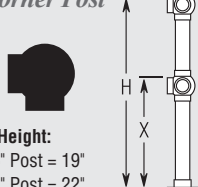

X Height:
36" Post = 19"
42" Post = 22"

Item#	Tubing	Height
D103/3	1 1/2"	36"
D203/3	2"	36"
D203/4	2"	42"

Center Post

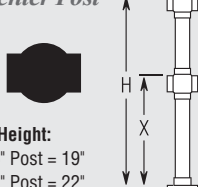

X Height:
36" Post = 19"
42" Post = 22"

Item#	Tubing	Height
D104/3	1 1/2"	36"
D204/3	2"	36"
D204/4	2"	42"

Tee Post

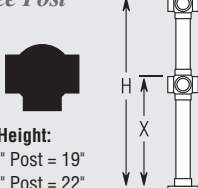

X Height:
36" Post = 19"
42" Post = 22"

Item#	Tubing	Height
D105/3	1 1/2"	36"
D205/3	2"	36"
D205/4	2"	42"

135° Corner Post

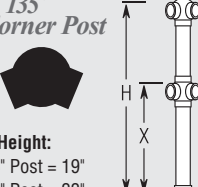

X Height:
36" Post = 19"
42" Post = 22"

Item#	Tubing	Height
D108/3	1 1/2"	36"
D208/3	2"	36"
D208/4	2"	42"

LOW LINE BALL POSTS

End Post

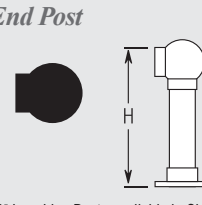

Item#	Tubing	Height
L102/1	1 1/2"	12"
L202/1	2"	12"

*1" Low Line Posts available in Chrome, Lido-Tone, and Brass finish only.

Corner Post

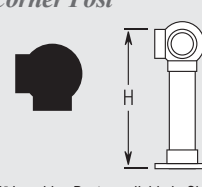

Item#	Tubing	Height
L103/1	1 1/2"	12"
L203/1	2"	12"

*1" Low Line Posts available in Chrome, Lido-Tone, and Brass finish only.

Center Post

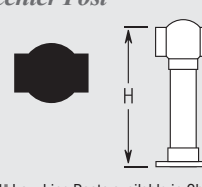

Item#	Tubing	Height
L104/1	1 1/2"	12"
L204/1	2"	12"

*1" Low Line Posts available in Chrome, Lido-Tone, and Brass finish only.

Tee Post

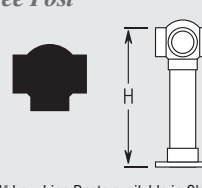

Item#	Tubing	Height
L105/1	1 1/2"	12"
L205/1	2"	12"

*1" Low Line Posts available in Chrome, Lido-Tone, and Brass finish only.

135° Corner Post

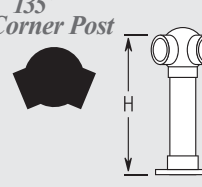

Item#	Tubing	Height
L108/1	1 1/2"	12"
L208/1	2"	12"

Mounting Solutions:

Mounting Hardware Sold Separately

Please review the Mounting Solutions Specification Sheet to choose the mounting option best suited to your project. Mounting solutions are priced individually and need to be added to the "Factory Assembled" post prices.

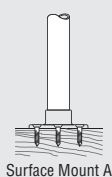

Surface Mount A

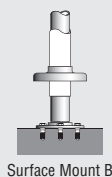

Surface Mount B

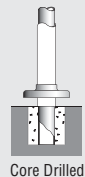

Core Drilled

Tubing:

Item#	Dia.	Thickness
A100	1"	.050
A110	1 1/2"	.050
A120	2"	.050

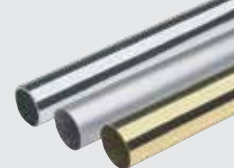

Pre-Fab Flush Posts

Factory-assembled posts arrive ready for installation

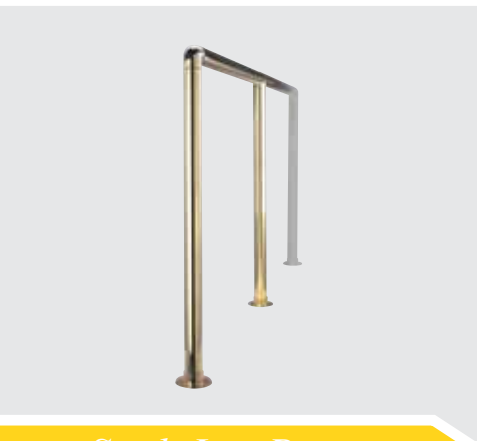
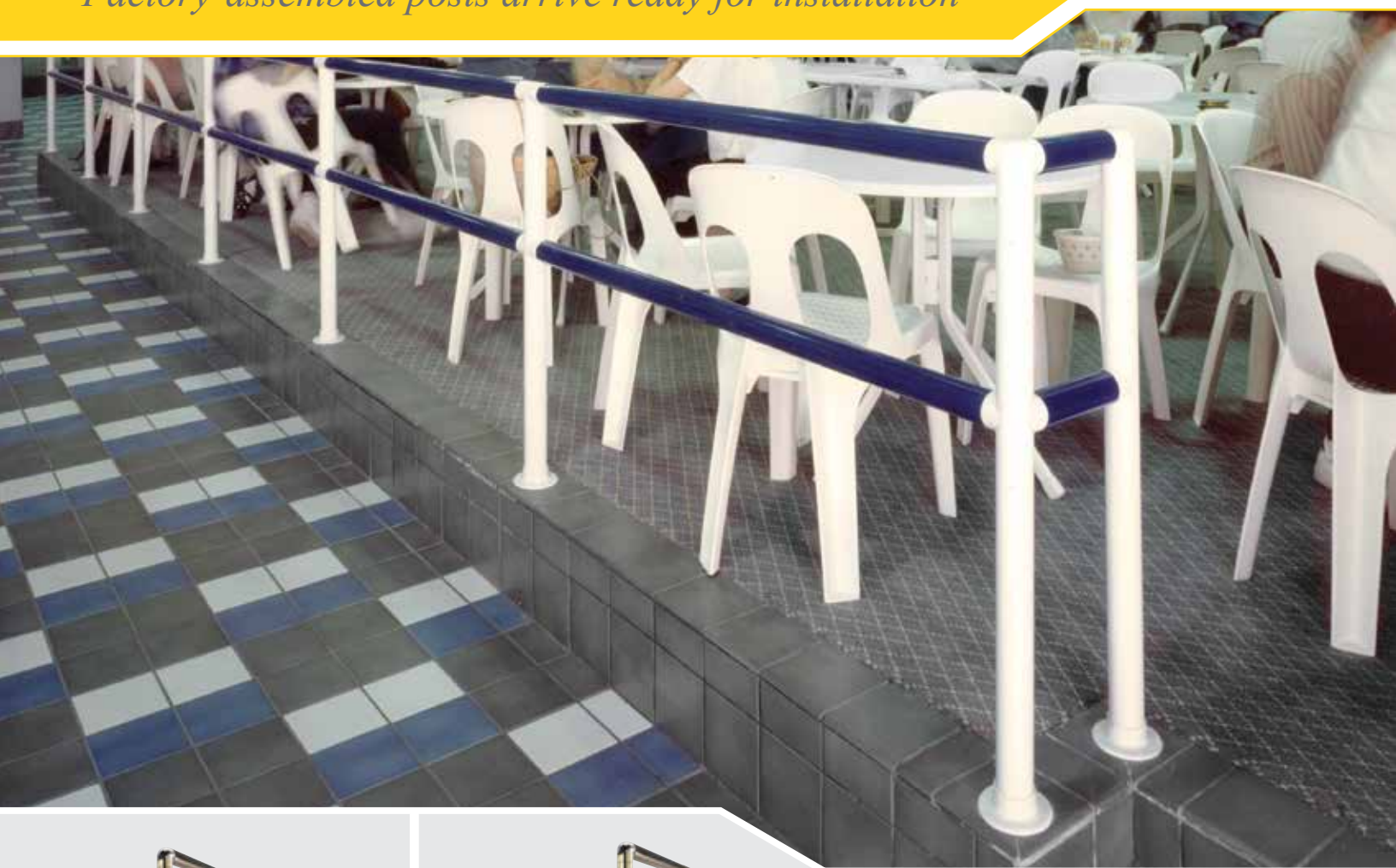

Single Line Posts

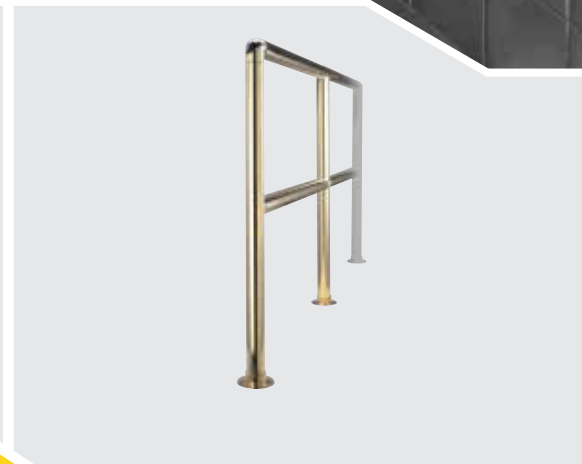

Double Line Posts



Low Line Posts



- Prefabricated for quick and easy installation
- Factory welded posts provide for greater strength
- Space posts no greater than 4 feet apart for maximum stability

Pre-Fab Flush Posts

Factory-assembled posts arrive ready for installation

Custom and special orders available. Please call for quote.

Polished
Stainless Steel



Satin
Stainless Steel

SINGLE LINE FLUSH POSTS

End Post



Item#	Tubing	Height
S132/3	1 1/2"	36"
S232/3	2"	36"
S232/4	2"	42"

Corner Post



Item#	Tubing	Height
S133/3	1 1/2"	36"
S233/3	2"	36"
S233/4	2"	42"

Center Post



Item#	Tubing	Height
S134/3	1 1/2"	36"
S234/3	2"	36"
S234/4	2"	42"

Tee Post



Item#	Tubing	Height
S135/3	1 1/2"	36"
S235/3	2"	36"
S235/4	2"	42"

135° Corner Post

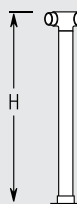

Item#	Tubing	Height
S138/3	1 1/2"	36"
S238/3	2"	36"
S238/4	2"	42"

DOUBLE LINE FLUSH POSTS

End Post

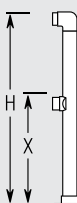

X Height:
36" Post = 19"
42" Post = 22"

Item#	Tubing	Height
D132/3	1 1/2"	36"
D232/3	2"	36"
D232/4	2"	42"

Corner Post

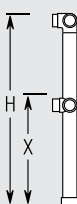

X Height:
36" Post = 19"
42" Post = 22"

Item#	Tubing	Height
D133/3	1 1/2"	36"
D233/3	2"	36"
D233/4	2"	42"

Center Post

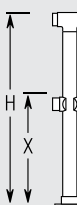

X Height:
36" Post = 19"
42" Post = 22"

Item#	Tubing	Height
D134/3	1 1/2"	36"
D234/3	2"	36"
D234/4	2"	42"

Tee Post

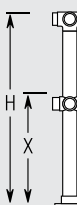

X Height:
36" Post = 19"
42" Post = 22"

Item#	Tubing	Height
D135/3	1 1/2"	36"
D235/3	2"	36"
D235/4	2"	42"

135° Corner Post

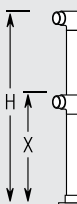

X Height:
36" Post = 19"
42" Post = 22"

Item#	Tubing	Height
D138/3	1 1/2"	36"
D238/3	2"	36"
D238/4	2"	42"

LOW LINE FLUSH POSTS

End Post



Item#	Tubing	Height
L132/1	1 1/2"	12"
L232/1	2"	12"

Corner Post



Item#	Tubing	Height
L133/1	1 1/2"	12"
L233/1	2"	12"

Center Post



Item#	Tubing	Height
L134/1	1 1/2"	12"
L234/1	2"	12"

Tee Post



Item#	Tubing	Height
L135/1	1 1/2"	12"
L235/1	2"	12"

135° Corner Post

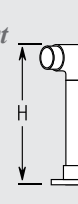

Item#	Tubing	Height
L138/1	1 1/2"	12"
L238/1	2"	12"

Mounting Solutions:

Mounting Hardware Sold Separately

Please review the Mounting Solutions Specification Sheet to choose the mounting option best suited to your project. Mounting solutions are priced individually and need to be added to the "Factory Assembled" post prices.

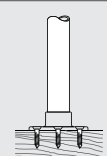

Surface Mount A

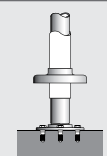

Surface Mount B

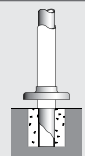

Core Drilled

Tubing:

Item#	Dia.	Thickness
A100	1"	.050
A110	1 1/2"	.050
A120	2"	.050

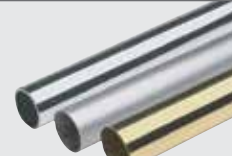

Mounting Solutions

Solid Brass and Stainless Steel Components



Mounting solutions to solve the most common installation problems.

Mounting Solutions

Solid Brass and Stainless Steel Components

Standard Finishes & Materials: Polished Brass, Polished Stainless Steel, & Satin Stainless Steel.

In addition to our standard finishes, Brass Clear Coat & Lido Tone finishes may be available. Please call for details.

	BRASS
	STAINLESS STEEL
	BRASS & STAINLESS STEEL

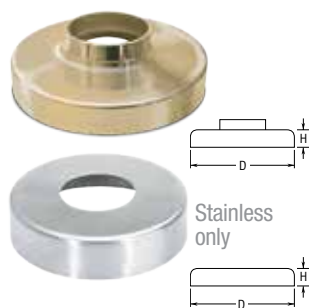

540
Flange Canopy

Item#	Tubing	D	H
● 540/1H	1 1/2"	4.13"	1"
● 540/2	2"	5.13"	1"

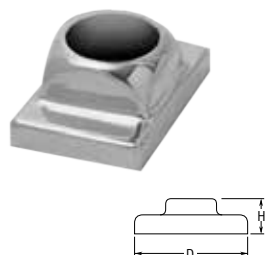

540C
Cut Flange Canopy

Item#	Tubing	D	H
● 540C/1H	1 1/2"	4 1/2"	1 3/4"
● 540C/2	2"	4 1/2"	1 3/4"

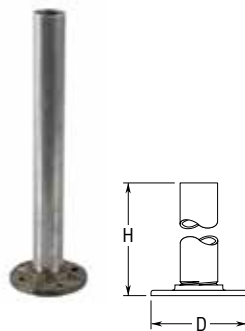

20-541
Steel Flange w/ Steel Insert

Item#	Tubing	D	H
20-541/1H	1 1/2"	3 1/2"	12"
20-541/2	2"	4 1/2"	12"

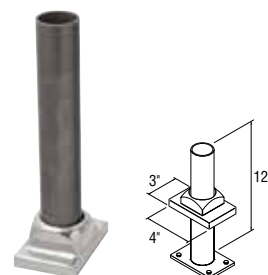

542/SET & 543/SET
Mounting Flange & Canopy

Item#	Tubing
● 542/SET	2"
● 543/SET	1 1/2"

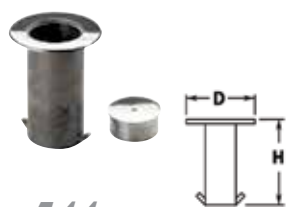

544
Floor Socket and Cap

Item#	Tubing	D	H
● 544/2	2"	2 7/8"	4 3/4"

Note: 544/2 includes both Socket and Cap, 544/2CAP is a Replacement Cap only.

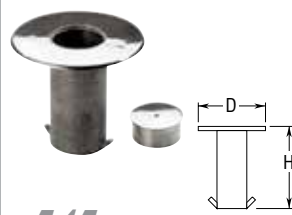

545
Floor Socket and Cap

Item#	Tubing	D	H
● 545/2	2"	4 7/8"	4 1/2"

Note: 545/2 includes both Socket and Cap, 545/2CAP is a Replacement Cap only.

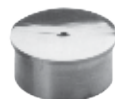

544/2CAP
545/2CAP
Replacement Cap

Item#	Tubing	D	H
● 544/2CAP	2"	2 1/8"	7/8"
● 545/2CAP	2"	2 1/8"	3/4"



512
4" Floor Flange

Item#	Tubing	D	H
● 512/1H	1 1/2"	4"	1 1/4"

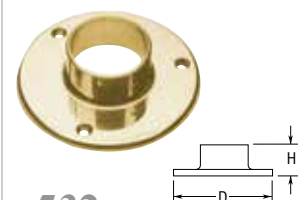

532
5" Floor Flange

Item#	Tubing	D	H
● 532/2	2"	5"	1 3/8"

Mounting Solutions

Type A Surface Mount

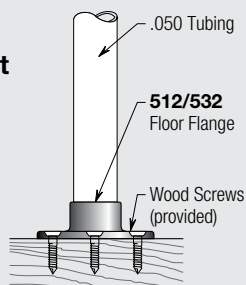

Type B Surface Mount

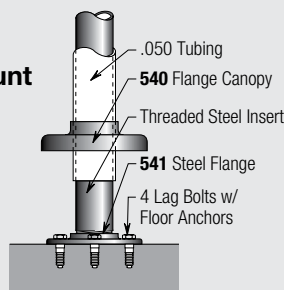

Type C Core Drilled

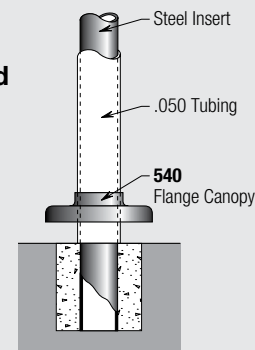

Please check our current price list for ongoing information updates.

Lavi Industries

877.ASK.LAVI | railings@lavi.com | www.railings.lavi.com

© 2014 Lavi Industries All rights reserved.
All product design is the property of Lavi Industries.
SPEC-RF-0106-0509

Glass Clips

Solid Brass and Stainless Steel Components



*The perfect solution for booth dividers,
guard rails, shelving and more!*

Glass Clips

Solid Brass and Stainless Steel Components

Standard Finishes & Materials: Polished Brass, Polished Stainless Steel, & Satin Stainless Steel.

	BRASS
	STAINLESS STEEL
	BRASS & STAINLESS STEEL

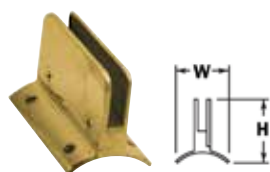

812

1/4" Glass Clip

Item#	Tubing	W	H
● 812/1H	1 1/2"	1 1/2"	1 1/2"
● 812/2	2"	1 1/2"	1 1/2"



812/SL & SR

1/4" Glass Clip w/ Stop

Item#	Tubing	W	H
● 812/1HSL	1 1/2"	1 1/2"	1 3/4"
● 812/1HSR	1 1/2"	1 1/2"	1 3/4"
● 812/2SL	2"	1 3/8"	1 3/16"
● 812/2SR	2"	1 3/8"	1 3/16"

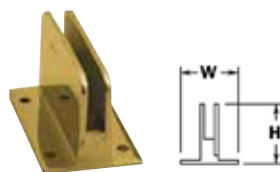

812F

1/4" Glass Clip, Flat Back

Item#	W	H
● 812F	3/4"	1 3/4"



813

1/2" Glass Clip

Item#	Tubing	W	H
● 813	2"	1 3/16"	1 1/2"



813/SL & SR

1/2" Glass Clip w/ Stop

Item#	Tubing	W	H
● 813/SL	2"	3/4"	1 3/8"
● 813/SR	2"	3/4"	1 3/8"



813F

1/2" Glass Clip, Flat Back

Item#	W	H
● 813F	1 3/16"	1 3/8"



813/03

3/8" Glass Clip

Item#	Tubing	W	H
● 813/03	2"	1 3/16"	1 3/8"



813/03SL & 03SR

3/8" Glass Clip w/ Stop

Item#	Tubing	W	H
● 813/03SL	2"	1 1/16"	1 3/8"
● 813/03SR	2"	1 1/16"	1 3/8"



813/03F

3/8" Glass Clip, Flat Back

Item#	W	H
● 813/03F	1 3/16"	1 3/8"

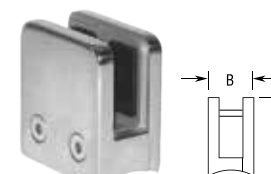

813/2

1/2" GlassGrip™

Item#	Tubing	A	B
● 813/2	2"	2 15/16"	1 5/16"

Includes pin and gasket.

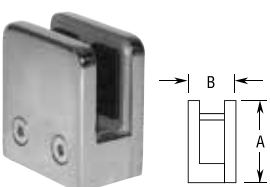

813G/F

1/2" GlassGrip™, Flat Back

Item#	A	B
● 813G/F	2 3/16"	1 5/16"

Includes pin and gasket.



813R/2

1/2" GlassGrip™

Item#	Tubing	A	B
● 813R/2	2"	2 9/16"	1 7/16"

Includes pin and gasket.



813R/F

1/2" GlassGrip™, Flat Back

Item#	A	B
● 813R/F	2 5/16"	1 7/16"

Includes pin and gasket.



816

1/4" - 3/8" GlassGrip™

Item#	Tubing	A	B
● 816/1*	1"	1 11/16"	1"
● 816/1H	1 1/2"	2 1/2"	1 1/16"
● 816/2	2"	2 1/4"	1 5/16"

Includes pin and gasket.



816F

1/4" - 3/8" GlassGrip™, Flat Back

Item#	A	B
● 816/F	2 1/4"	1 5/16"
● 816/FM*	1 9/16"	1 1/16"

Includes pin and gasket.
*For 1/4" glass only.

Please check our current price list for ongoing information updates.

Booth Dividers

Factory-assembled posts arrive ready for installation



- Height of post can be customized to accommodate your panels.
- Recommended post spacing: 36" to 48".
- Holds 1/4" or 3/8" panels.
- Glass panels are available.
Please call for more information.

Booth Dividers

Factory-assembled posts arrive ready for installation

Custom and special orders available. Please call for quote.



	END POST	CORNER POST	CENTER POST	TEE POST
SHORT POST	<div></div> <div></div>	<div></div> <div></div>	<div></div> <div></div>	<div></div> <div></div>
DOME POST	<div></div> <div></div>	<div></div> <div></div>	<div></div> <div></div>	<div></div> <div></div>
BALL POST	<div></div> <div></div>	<div></div> <div></div>	<div></div> <div></div>	<div></div> <div></div>
SQUARE POST	<div></div> <div></div>	<div></div> <div></div>	<div></div> <div></div>	<div></div> <div></div>
GLASS GRIP POST	<div></div> <div></div>	<div></div> <div></div>	<div></div> <div></div>	<div></div> <div></div>
GLASS GRIP POST	<div></div> <div></div>	<div></div> <div></div>	<div></div> <div></div>	<div></div> <div></div>
MOUNTING OPTIONS	<div>Booth Dividers are pre-assembled with standard wall flanges. Narrow (cut) flanges may be substituted at no additional charge.</div>			
1 1/2" FLANGES	<div>Standard:<div></div></div>			
2" FLANGES	<div>Standard:<div></div></div>			
Optional:	<div>Optional:<div></div><div></div></div>			

* NEW PRODUCT! 1-INCH POSTS!

Lavi Industries

877.ASK.LAVI | railings@lavi.com | www.railings.lavi.com

© 2019 Lavi Industries. All rights reserved.
All product design is the property of Lavi Industries.
SPEC-RF-0102-0509

Tubing and Extrusions

Solid Brass and Stainless Steel



- Solid Brass with polished or clear coat finish
- Polished or Satin Stainless Steel, Alloy 304
- Lido-Tone powder coated finish in a wide variety of colors
- Available in mill lengths
- Cutting service is available

Reeded Solid Brass Round Tubing

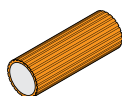

Item#	Diameter (in.)	lbs./ft.	Mill ft.
A100R	1	.270	12
A110R	1-1/2	.448	12
A120R	2	.599	12

Solid Brass Round Tubing

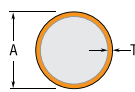

Item#	A (in.)	T (in.)	lbs./ft.	Mill ft.
A50	1/2	.050	.257	12
A60	5/8	.040	.328	12
A70	3/4	.050	.398	12
A100	1	.050	.541	12
A110	1-1/2	.050	.830	12,16
A110ID	1-1/2 ID	•	•	16
A120	2	.050	1.080	12,16
A120ID	2 ID	•	•	16
A121	2	.060	1.460	16

Lido-Tone® Round Tubing

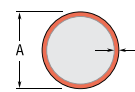

Item#	A (in.)	T (in.)	lbs./ft.	Mill ft.
A120	2	.050	1.460	16

Spirated Solid Brass Round Tubing



Item#	Diameter (in.)	lbs./ft.	Mill ft.
A100S	1	.246	12
A110S	1-1/2	.571	12
A120S	2	.765	12

Polished Chrome Round Tubing

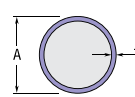

Item#	A (in.)	T (in.)	lbs./ft.	Mill ft.
A100	1	.050	.500	12
A110	1-1/2	.050	.760	12
A120	2	.050	1.030	12

Steel Sleeve for Round Tubing

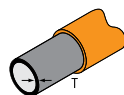

Item#	Use With Tubing	lbs./ft.	Mill ft.	T (in.)
A100SL	A100	.563	20	.875
A110SL	A110	1.328	12	.104
A120SL	A120	1.922	12	.109

Stainless Steel Round Tubing

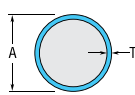

Item#	A (in.)	T (in.)	lbs./ft.	Mill ft.
A60	5/8	.040	.328	12
A100	1	.050	.510	20
A110	1.5	.050	.770	20
A111	1.5	.060	.990	20
A114	1.67	.080		20
A120	2	.050	1.020	20
A121	2	.060	1.300	20

Solid Brass Square Tubing

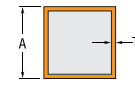

Item#	A (in.)	T (in.)	lbs./ft.	Mill ft.
C12121	1-1/2	.050	1.070	12
C16161	2	.050	1.440	12
C16162	2	.060	1.860	12

Tubing Splice Round Tubing

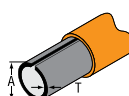

Item#	A (in.)	T (in.)	Length
830/1	1	.050	6"
830/1H	1-1/2	.050	6"
830/2	2	.050	6"

Tubing and Extrusions

Solid Brass and Stainless Steel

Please check current price list for availability of materials and finishes.

Configuring a Part Number for Ordering: Finish-Item#/Length

EXAMPLE:

5/8" x 5/8" SOLID BRASS CHANNEL IN POLISHED BRASS IN 12' LENGTH=

00-**U05053**/**12**

Finish Item Number Length

Brass	Stainless Steel	Chrome	LidoTone®	Aluminum
00- Polished	40- Polished	10- Over Steel	26- Over Steel	50- Aluminum
01- Mill	41- Mill	12- Over Brass	06- Over Brass	
02- Clear Coat	44- Satin			
	47- Polished 316			
	49- Satin 316			

Note: Items listed in **bold** type below are commonly used with our Fittings and Components.

Aluminum Base

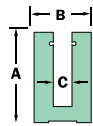

Item#	A (in.)	B (in.)	C (in.)	lbs./ft.	Mill ft.
A123B	4-1/8	2½	1	8.00	20

Stainless Steel Channel Tubing

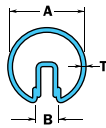

Item#	A (in.)	B (in.)	T (in.)	lbs./ft.	Mill ft.
A121U	2	3/4	.062	1.950	10
A132U	2½	3/4	.062	2.300	10, 20

Stainless Steel Radius Back Channel

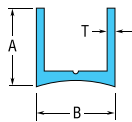

Item#	A (in.)	B (in.)	T (in.)	lbs./ft.	Mill ft.
U03052C	5/8	3/8	.065	.350	12
U04052C	5/8	1/2	.065	.320	12

Solid Brass Handrail Cap Extrusion

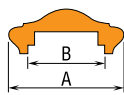

Item#	A (in.)	B (in.)	lbs./ft.	Mill ft.
H1600	2	1-5/16	2.280	16, 20
H1800	2-1/4	1-9/16	2.910	16

For a full line of fittings for the H1600, refer to spec sheet for Cap Rail Components.

Solid Brass Angle

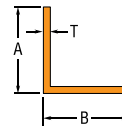

Item#	A (in.)	B (in.)	T (in.)	lbs./ft.	Mill ft.
L04042	1/2	1/2	.065	.220	12
L04043	1/2	1/2	.090	.312	12
L04044	1/2	1/2	.125	.420	12
L06062	3/4	3/4	.065	.320	12
L06064	3/4	3/4	.125	.630	12
L08082	1	1	.065	.460	12
L08084	1	1	.125	.890	12
L12124	1½	1½	.125	1.220	12

Solid Brass Channel

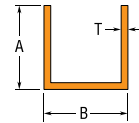

Item#	A (in.)	B (in.)	T (in.)	lbs./ft.	Mill ft.
U03032	3/8	3/8	.062	.190	12
U04043	1/2	1/2	.094	.440	12
U04083	3/4	1/2	.094	.600	12
U05053	5/8	5/8	.094	.570	12
U06063	3/4	3/4	.094	.690	12

Solid Brass Radius Back Channel

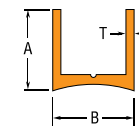

Item#	A (in.)	B (in.)	T (in.)	lbs./ft.	Mill ft.
U04043C	1/2	1/2	.094	.464	12
U05053C	5/8	5/8	.094	.700	12

Please check our current price list for ongoing information updates.

Accessories

00202

Lavi Metal Polish



Developed especially for high-shine or polished finishes.

Lavi Metal Polish instantly removes years of residue, rust, tarnish and oxidation from all polished-finish metals. Lavi Metal Polish applies a superstrong anti-tarnish corrosion inhibitor and imparts a long-lasting protective shine to all your metal surfaces. While it works on all metals, it is best-suited for a high-shine or polished finish.

- Easy, just wipe-on & wipe-off
- Cleans, polishes and protects
- Anti-tarnish protection
- Fresh lavender scent

NOTE: This polish is designed to remove scratches and may alter the appearance of a satin-finished or brushed metal product.

00201

Loctite 326 Adhesive



A strong structural adhesive for joining metal components. Originally designed to work specifically with brass components, this adhesive provides a cohesive bond within minutes. When working with stainless steel, expect a longer cure-time, anywhere from a few hours to overnight. If a faster cure-time is desired, use the Loctite 7649 Primer to bond stainless steel components in minutes. Loctite Metal Adhesive will simplify your project assembly while achieving a professional look.

00211

Primer for Stainless Steel



Loctite 7649 Primer is used in conjunction with Loctite Metal Adhesive for stainless steel components. Loctite 7649 Primer is sprayed or brushed on the metal as a primer to speed the curing time of the Adhesive, reducing the set-time to mere minutes during installation.

00203

MAAS Stainless Steel and Chrome Cleaner



- No powder or oily residue
- Contains no acids or abrasives
- Polishes, protects and repels dust and fingerprints

00204

MAAS Polishing Cloth



- Provides anti-tarnish protection
- Provides instant touch-ups
- Reusable

RMK01

Maintenance Kit



RMK02

Maintenance Kit



316 Stainless Steel

We also offer a full line of premium 316 Stainless Steel components and tubing, including prefabricated posts which can greatly reduce labor costs and simplify the installation process.



*Call today to find out more
about this exciting line:
800-624-6225.*



877.ASK.LAVI
railings@lavi.com
www.railings.lavi.com

© 2019 Lavi Industries
All product design is the property of
Lavi Industries. All rights reserved.



© Lavi Industries. All Rights Reserved.

Lido-Tone and GlassGrip are registered trademarks of Lavi Industries.

All product designs © Lavi Industries.

No part of this catalog may be reproduced or transmitted in any form or by any means, electronic or mechanical, including photocopying, recording, or by any information storage and retrieval system, without prior written permission from Lavi Industries.

Lavi Industries has a policy of continuous development and improvement to our product line. Specifications, data, and dimensions may change without notice. When these specifications or colors are critical, consult the factory for current information.

Lavi Industries *Architectural Railing and Fittings*

Texas Office

5885 E. Houston Street,
San Antonio, TX 78220

California Office

27810 Avenue Hopkins
Valencia, CA 91355

www.railings.lavi.com • railings@lavi.com • 877.275.5284