



# Cross Bar Railing Systems



SUMMER 2021

 Lavi Industries



# Prefabricated Railing Assemblies for Cross Bars

*Post assemblies simplify installation and eliminate welding.*

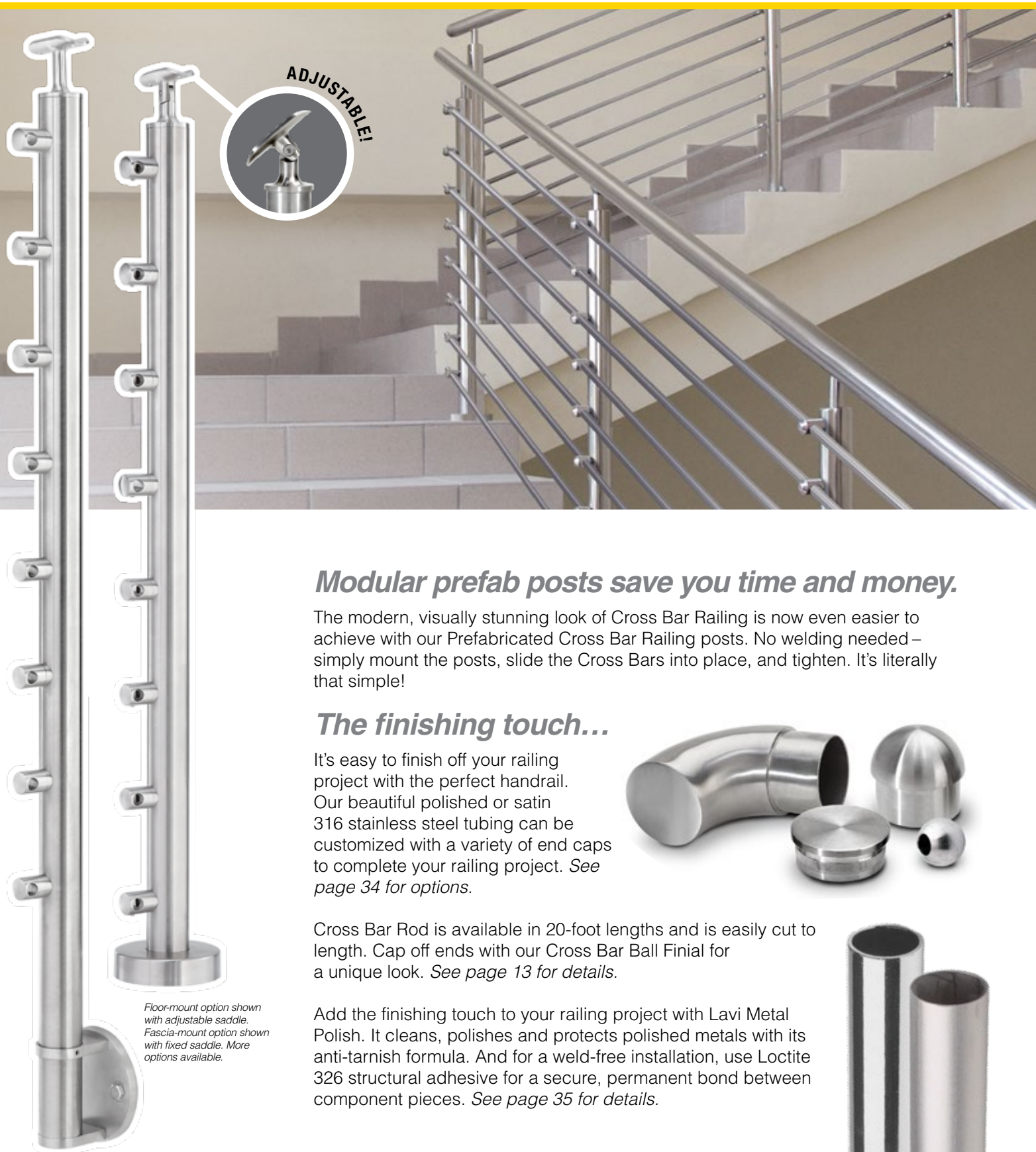

## ***Modular prefab posts save you time and money.***

The modern, visually stunning look of Cross Bar Railing is now even easier to achieve with our Prefabricated Cross Bar Railing posts. No welding needed – simply mount the posts, slide the Cross Bars into place, and tighten. It's literally that simple!

## ***The finishing touch...***

It's easy to finish off your railing project with the perfect handrail. Our beautiful polished or satin 316 stainless steel tubing can be customized with a variety of end caps to complete your railing project. See *page 34* for options.



Cross Bar Rod is available in 20-foot lengths and is easily cut to length. Cap off ends with our Cross Bar Ball Finial for a unique look. See *page 13* for details.

Add the finishing touch to your railing project with Lavi Metal Polish. It cleans, polishes and protects polished metals with its anti-tarnish formula. And for a weld-free installation, use Loctite 326 structural adhesive for a secure, permanent bond between component pieces. See *page 35* for details.

*Floor-mount option shown with adjustable saddle. Fascia-mount option shown with fixed saddle. More options available.*

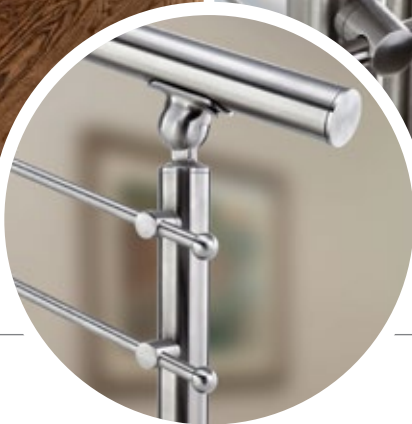

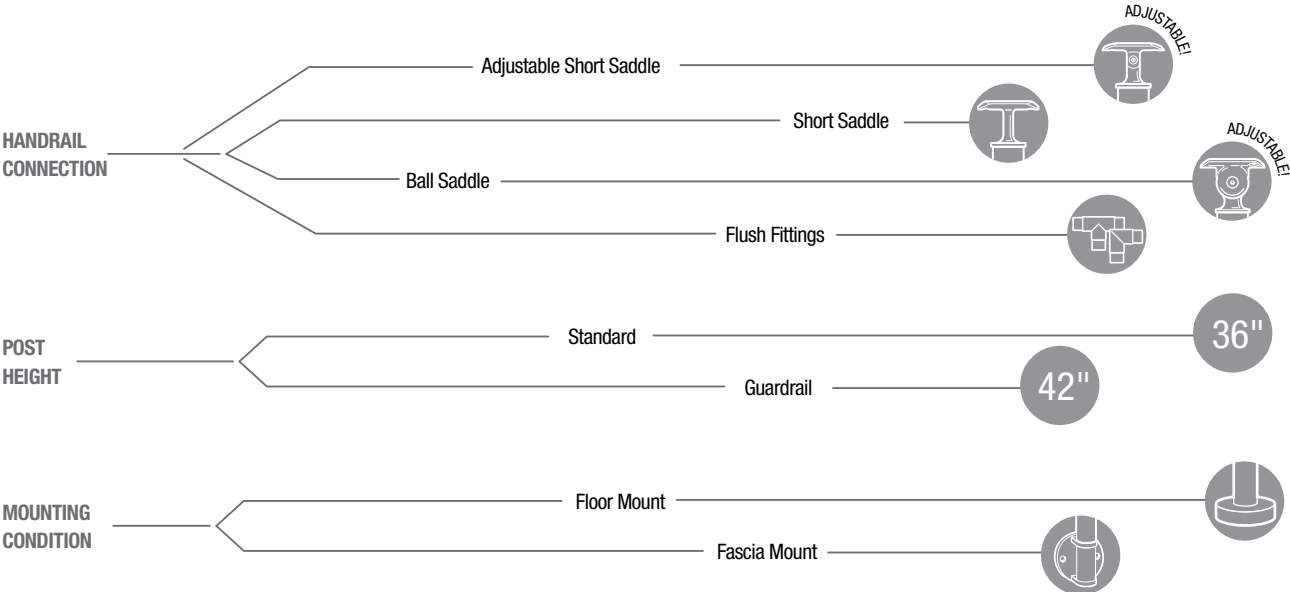

# Prefabricated Post Options



# Cross Bar Posts for 36" and 42" Handrail

## Short Adjustable Saddle



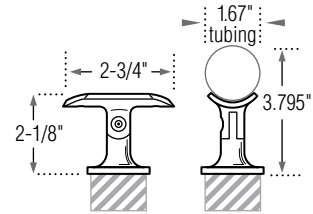

| MOUNTING CONDITION  | POST HEIGHT/ FINISH | ITEM #            | ROD DIAMETER | POSITION/ CONNECTION | POST DIAMETER |
|---|---------------------|-------------------|--------------|----------------------|---------------|
|  | 36" Satin           | CB/4S/CN/36/AR/FL | .47"         | Ends, Center         | 1.67"         |
|   | 42" Satin           | CB/4S/CN/42/AR/FL | .47"         | Ends, Center         | 1.67"         |
|  | 36" Satin           | CB/4S/CN/36/AR/FM | .47"         | Ends, Center         | 1.67"         |
|   | 42" Satin           | CB/4S/CN/42/AR/FM | .47"         | Ends, Center         | 1.67"         |

Dimensions for Adjustable Saddle



## Short Saddle (non-adjustable)



| MOUNTING CONDITION   | POST HEIGHT/ FINISH | ITEM #            | ROD DIAMETER | POSITION/ CONNECTION | POST DIAMETER |
|--|---------------------|-------------------|--------------|----------------------|---------------|
|   | 36" Satin           | CB/4S/CN/36/FR/FL | .47"         | Ends, Center         | 1.67"         |
|  | 42" Satin           | CB/4S/CN/42/FR/FL | .47"         | Ends, Center         | 1.67"         |
|  | 36" Satin           | CB/4S/CN/36/FR/FM | .47"         | Ends, Center         | 1.67"         |
|  | 42" Satin           | CB/4S/CN/42/FR/FM | .47"         | Ends, Center         | 1.67"         |

Dimensions for Fixed Saddle saddle

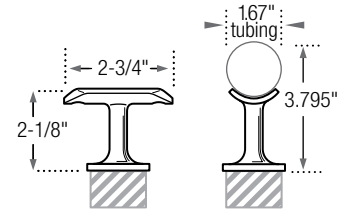

All posts also available in polished 316 stainless steel.

36" Standard

42" Guardrail

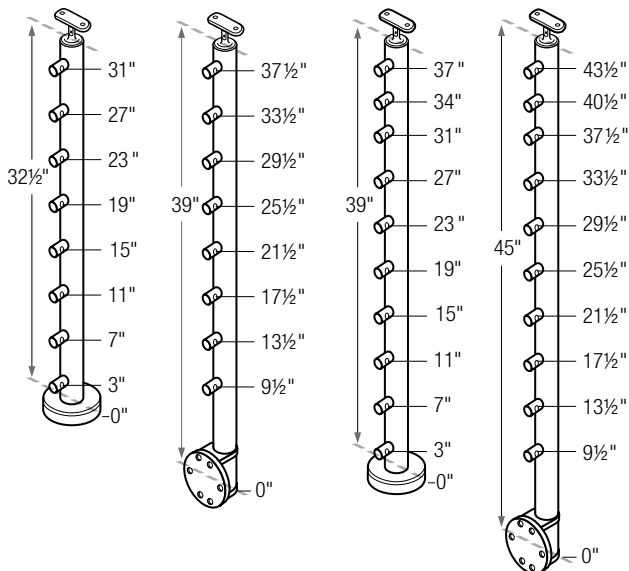

Cross Bar Positions

"Center" standoff Cross Bar holders are used on all prefabricated posts. Rod ends remain exposed on end-post positions. If finished ends are desired, end-right and end-left versions are sold separately.

Ends

Center

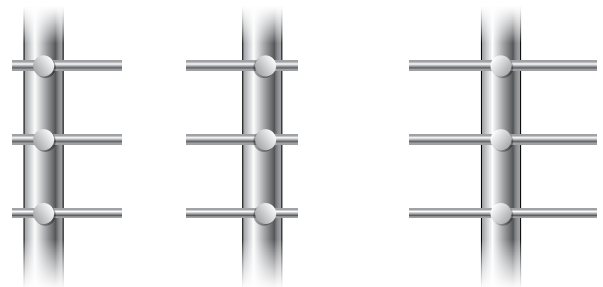



# Cross Bar Railing Connectors

## Cross Bar Rod

| ITEM #     | TYPE      | MATERIAL | FINISH   | OD    | WALL THICK | LENGTH |
|------------|-----------|----------|----------|-------|------------|--------|
| 49-R038/20 | Solid Rod | 316      | Satin    | 0.47" | NA         | 20'    |
| 47-R038/20 | Solid Rod | 316      | Polished | 0.47" | NA         | 20'    |

## Standoff Cross Bar Holder

| ITEM #        | MATERIAL | FINISH   | TUBE | MOUNTS ON | H     | D     | CP    | POSITION  |
|---------------|----------|----------|------|-----------|-------|-------|-------|-----------|
| 47-RH101/424  | 316      | Polished | 0.47 | 1.67"     | 1.02" | 0.85" | 0.79" | Center    |
| 49-RH101/424  | 316      | Satin    | 0.47 | 1.67"     | 1.02" | 0.85" | 0.79" | Center    |
| 49-RH102R/424 | 316      | Satin    | 0.47 | 1.67"     | 1.02" | 0.85" | 0.79" | End-Right |
| 49-RH102L/424 | 316      | Satin    | 0.47 | 1.67"     | 1.02" | 0.85" | 0.79" | End-Left  |

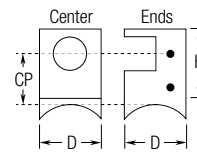

## Cross Bar Ball Finial

| ITEM #    | MATERIAL | FINISH   | TUBE  | D1    | D2    |
|-----------|----------|----------|-------|-------|-------|
| 49-RCF101 | 316      | Machined | 0.47" | 0.79" | 0.48" |

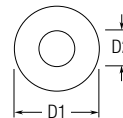

## Cross Bar Splice

| ITEM #   | MATERIAL | FINISH   | TUBE  |
|----------|----------|----------|-------|
| 49-RC103 | 316      | Satin    | 0.47" |
| 47-RC103 | 316      | Polished | 0.47" |



# Flush Fittings

Flush fittings allow for a large variety of tube connection options, for railing or other projects such as bathroom sink vanities or store shelving/displays. A variety of 90 degree angle options are available. Plus by using an adjustable ell, you can create additional angles.

## Flush 135° Angle

Useful for creating 45° angle when using one and 90° angles when using two of these.

| ITEM #      | MATERIAL | FINISH   | TUBE  | WALL THICK | W1    | W2    | L     |
|-------------|----------|----------|-------|------------|-------|-------|-------|
| 49-730/424  | 316      | Satin    | 1.67" | 0.08"      | 1.97" | 2.60" | 3.34" |
| 47-730/424  | 316      | Polished | 1.67" | 0.08"      | 1.97" | 2.60" | 3.34" |
| 49-730/1H16 | 316      | Satin    | 1.5"  | .06"       | 1.77" | Call  | 3.18" |
| 47-730/1H16 | 316      | Polished | 1.5"  | .06"       | 1.77" | Call  | 3.18" |
| 49-730/216  | 316      | Satin    | 2"    | .06"       | 1.96" | Call  | 3.30" |
| 47-730/216  | 316      | Polished | 2"    | .06"       | 1.96" | Call  | 3.30" |

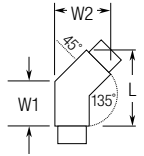

## Flush Radius Ell

Connect two tubes at a 90° angle.

| ITEM #      | MATERIAL | FINISH   | TUBE  | WALL THICK | W     | L     |
|-------------|----------|----------|-------|------------|-------|-------|
| 49-731/424  | 316      | Satin    | 1.67" | 0.08"      | 2.55" | 2.55" |
| 47-731/424  | 316      | Polished | 1.67" | 0.08"      | 2.55" | 2.55" |
| 49-731/1H16 | 316      | Satin    | 1.5"  | .06"       | 2.87" | 2.87" |
| 47-731/1H16 | 316      | Polished | 1.5"  | .06"       | 2.87" | 2.87" |
| 49-731/216  | 316      | Satin    | 2"    | .06"       | 2.96" | 2.96" |
| 47-731/216  | 316      | Polished | 2"    | .06"       | 2.96" | 2.96" |

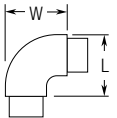

## Adjustable Radius Ell

Same look as the Flush Radius Ell and can be used for various angles.

| ITEM #      | MATERIAL | FINISH   | TUBE  | WALL THICK | W     | L     |
|-------------|----------|----------|-------|------------|-------|-------|
| 49-731A/424 | 316      | Satin    | 1.67" | 0.08"      | 2.76" | 2.76" |
| 47-731A/424 | 316      | Polished | 1.67" | 0.08"      | 2.76" | 2.76" |

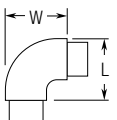

## Flush Ell

Connect two tubes at a 90° angle.

| ITEM #      | MATERIAL | FINISH   | TUBE  | WALL THICK | W     | L     |
|-------------|----------|----------|-------|------------|-------|-------|
| 49-732/424  | 316      | Satin    | 1.67" | 0.08"      | 2.56" | 2.56" |
| 47-732/424  | 316      | Polished | 1.67" | 0.08"      | 2.56" | 2.56" |
| 49-732/1H16 | 316      | Satin    | 1.5"  | .06"       | 2.25" | 2.25" |
| 47-732/1H16 | 316      | Polished | 1.5"  | .06"       | 2.25" | 2.25" |
| 49-732/216  | 316      | Satin    | 2"    | .06"       | 2.75" | 2.75" |
| 47-732/216  | 316      | Polished | 2"    | .06"       | 2.75" | 2.75" |



## Adjustable Flush Ell

Connect two tubes at various angles.

| ITEM #       | MATERIAL | FINISH   | TUBE  | WALL THICK | H     |
|--------------|----------|----------|-------|------------|-------|
| 49-732A/424  | 316      | Satin    | 1.67" | 0.08"      | 2.10" |
| 47-732A/424  | 316      | Polished | 1.67" | 0.08"      | 2.10" |
| 49-732A/1H16 | 316      | Satin    | 1.5"  | .06"       | 1.75" |
| 47-732A/1H16 | 316      | Polished | 1.5"  | .06"       | 1.75" |
| 49-732A/216  | 316      | Satin    | 2"    | .06"       | 2.12" |
| 47-732A/216  | 316      | Polished | 2"    | .06"       | 2.12" |



## Flush Side Outlet Ell

Connect three tubes at 90° angles.

| ITEM #      | MATERIAL | FINISH   | TUBE  | WALL THICK | W     | L     |
|-------------|----------|----------|-------|------------|-------|-------|
| 49-733/424  | 316      | Satin    | 1.67" | 0.08"      | 2.56" | 2.56" |
| 47-733/424  | 316      | Polished | 1.67" | 0.08"      | 2.56" | 2.56" |
| 49-733/1H16 | 316      | Satin    | 1.5"  | .06"       | 2.25" | 2.25" |
| 47-733/1H16 | 316      | Polished | 1.5"  | .06"       | 2.25" | 2.25" |
| 49-733/216  | 316      | Satin    | 2"    | .06"       | 2.75" | 2.75" |
| 47-733/216  | 316      | Polished | 2"    | .06"       | 2.75" | 2.75" |

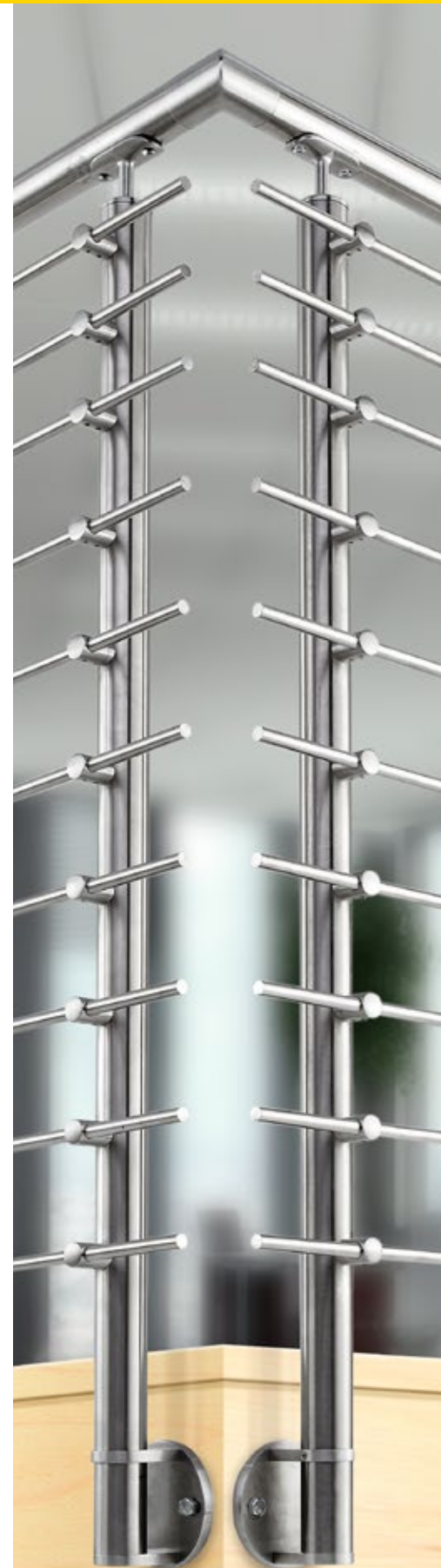



# Flush Fittings



## Flush Tee

Connect three tubes: one at a 90° angle and two in a straight line.

| ITEM #      | MATERIAL | FINISH   | TUBE  | WALL THICK | W     | L     |
|-------------|----------|----------|-------|------------|-------|-------|
| 49-734/424  | 316      | Satin    | 1.67" | 0.08"      | 3.43" | 2.56" |
| 47-734/424  | 316      | Polished | 1.67" | 0.08"      | 3.43" | 2.56" |
| 49-734/1H16 | 316      | Satin    | 1.5"  | .06"       | 3.02" | 2.25" |
| 47-734/1H16 | 316      | Polished | 1.5"  | .06"       | 3.02" | 2.25" |
| 49-734/216  | 316      | Satin    | 2"    | .06"       | 3.58" | 2.75" |
| 47-734/216  | 316      | Polished | 2"    | .06"       | 3.58" | 2.75" |

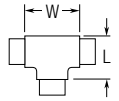

## Flush Side Outlet Tee

Commonly used when connecting center rails at 90° angles.

| ITEM #      | MATERIAL | FINISH   | TUBE  | WALL THICK | W     | L     |
|-------------|----------|----------|-------|------------|-------|-------|
| 49-735/424  | 316      | Satin    | 1.67" | 0.08"      | 3.5"  | 2.56" |
| 47-735/424  | 316      | Polished | 1.67" | 0.08"      | 3.5"  | 2.56" |
| 49-735/1H16 | 316      | Satin    | 1.5"  | .06"       | 3.02" | 2.25" |
| 47-735/1H16 | 316      | Polished | 1.5"  | .06"       | 3.02" | 2.25" |
| 49-735/216  | 316      | Satin    | 2"    | .06"       | 3.58" | 2.75" |
| 47-735/216  | 316      | Polished | 2"    | .06"       | 3.58" | 2.75" |

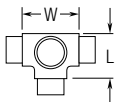

## Flush Cross

Rare fitting used to connect four tubes at 90° angles.

| ITEM #     | MATERIAL | FINISH   | TUBE  | WALL THICK | W     | L     |
|------------|----------|----------|-------|------------|-------|-------|
| 49-736/424 | 316      | Satin    | 1.67" | .08"       | 3.43" | 3.43" |
| 47-736/424 | 316      | Polished | 1.67" | .08"       | 3.43" | 3.43" |

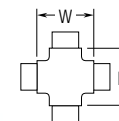



## Perpendicular Collar

Connect one tube to another by welding or using a screw and insert.

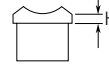

| ITEM #      | MATERIAL | FINISH   | TUBE  | WALL THICK | H     |
|-------------|----------|----------|-------|------------|-------|
| 49-818/424  | 316      | Satin    | 1.67" | 0.08"      | 0.25" |
| 47-818/424  | 316      | Polished | 1.67" | 0.08"      | 0.25" |
| 49-818/1H16 | 316      | Satin    | 1.5"  | .06"       | 0.25" |
| 47-818/1H16 | 316      | Polished | 1.5"  | .06"       | 0.25" |
| 49-818/216  | 316      | Satin    | 2"    | .06"       | 0.25" |
| 47-818/216  | 316      | Polished | 2"    | .06"       | 0.25" |



## Splice

Connects two tubes in a straight line with a small center piece in a matching finish.

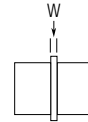

| ITEM #      | MATERIAL | FINISH   | TUBE  | WALL THICK | W     |
|-------------|----------|----------|-------|------------|-------|
| 49-830/424  | 316      | Satin    | 1.67" | 0.08"      | 0.16" |
| 47-830/424  | 316      | Polished | 1.67" | 0.08"      | 0.16" |
| 49-830/1H16 | 316      | Satin    | 1.5"  | 0.06"      | 0.20" |
| 47-830/1H16 | 316      | Polished | 1.5"  | 0.06"      | 0.20" |
| 49-830/216  | 316      | Satin    | 2"    | 0.06"      | 0.20" |
| 47-830/216  | 316      | Polished | 2"    | 0.06"      | 0.20" |

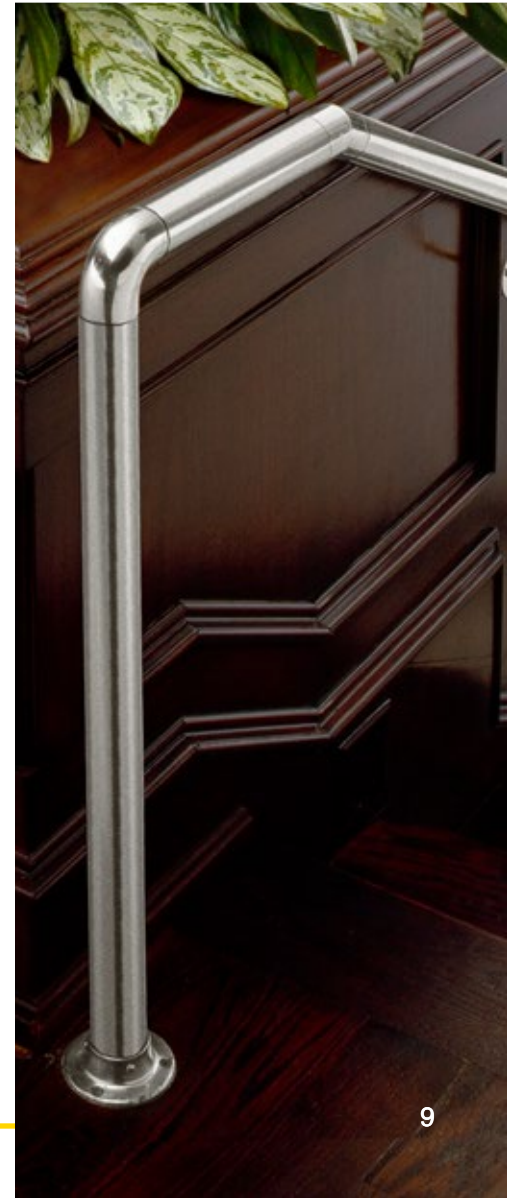

## Radius Wall Return

Brings the end of a wall-mounted handrail toward the wall.

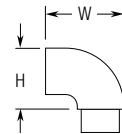

| ITEM #      | MATERIAL | FINISH   | TUBE  | WALL THICK | W     | H     |
|-------------|----------|----------|-------|------------|-------|-------|
| 49-608/424  | 316      | Satin    | 1.67" | 0.08"      | 2.56" | 2.56" |
| 47-608/424  | 316      | Polished | 1.67" | 0.08"      | 2.56" | 2.56" |
| 49-608/1H16 | 316      | Satin    | 1.5"  | 0.06"      | 3.00" | 3.00" |
| 47-608/1H16 | 316      | Polished | 1.5"  | 0.06"      | 3.00" | 3.00" |
| 49-608/216  | 316      | Satin    | 2"    | 0.06"      | 3.75" | 3.75" |
| 47-608/216  | 316      | Polished | 2"    | 0.06"      | 3.75" | 3.75" |



# End Caps and Finials

Finial options allow the end of a tube to be safely sealed. Radius wall returns offer the ability to wrap wall-mounted rail towards the wall. Flush end caps are designed to fit in by pressure: simply use a rubber hammer to hit the piece into place.

## End Caps

Flush End Cap provides a clean, flat end for tubing.

| ITEM #      | MATERIAL | FINISH   | WALL THICK | D    | H     |
|-------------|----------|----------|------------|------|-------|
| 49-600/1H16 | 316      | Satin    | 0.06"      | 1.5" | 0.13" |
| 47-600/1H16 | 316      | Polished | 0.06"      | 1.5" | 0.13" |
| 49-600/216  | 316      | Satin    | 0.06"      | 2"   | 0.13" |
| 47-600/216  | 316      | Polished | 0.06"      | 2"   | 0.13" |

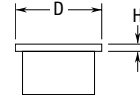

Knurled End Cap creates a flat, finished end for tubing. The knurled texture on the neck provides a secure pressure fit.

| ITEM #        | MATERIAL | FINISH   | WALL THICK | D     | H     |
|---------------|----------|----------|------------|-------|-------|
| 49-600PF/424  | 316      | Satin    | .08"       | 1.67" | 0.14" |
| 47-600PF/424  | 316      | Polished | .08"       | 1.67" | 0.14" |
| 49-600PF/1H16 | 316      | Satin    | .06"       | 1.5"  | 0.14" |
| 47-600PF/1H16 | 316      | Polished | .06"       | 1.5"  | 0.14" |
| 49-600PF/216  | 316      | Satin    | .06"       | 2"    | 0.14" |
| 47-600PF/216  | 316      | Polished | .06"       | 2"    | 0.14" |

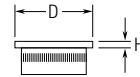

Half-ball Rounded End Cap creates a rounded, finished end for tubing.

| ITEM #     | MATERIAL | FINISH   | WALL THICK | D     | H     |
|------------|----------|----------|------------|-------|-------|
| 49-602/424 | 316      | Satin    | 0.08"      | 1.67" | 0.83" |
| 47-602/424 | 316      | Polished | 0.08"      | 1.67" | 0.83" |

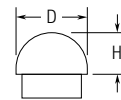

## Ball Finial

Decorative ball that closes the end of a vertical or horizontal tube

| ITEM #      | MATERIAL | FINISH   | TUBE  | WALL THICK | H     | D     |
|-------------|----------|----------|-------|------------|-------|-------|
| 49-604/424  | 316      | Satin    | 1.67" | 0.08"      | 4.09" | 2.75" |
| 47-604/424  | 316      | Polished | 1.67" | 0.08"      | 4.09" | 2.75" |
| 49-604/1H16 | 316      | Satin    | 1.5"  | 0.06"      | 4.05" | 2.75" |
| 47-604/1H16 | 316      | Polished | 1.5"  | 0.06"      | 4.05" | 2.75" |
| 49-604/216  | 316      | Satin    | 2"    | 0.06"      | 4.55" | 3.08" |
| 47-604/216  | 316      | Polished | 2"    | 0.06"      | 4.55" | 3.08" |

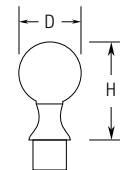

## Radius Wall Return

For details, please see page 33.





# Tubing

| ITEM #     | MATERIAL | FINISH   | OD    | WALL THICK | LENGTH |
|------------|----------|----------|-------|------------|--------|
| 49-A111/20 | 316      | Satin    | 1.5"  | 0.06"      | 20'    |
| 47-A111/20 | 316      | Polished | 1.5"  | 0.06"      | 20'    |
| 49-A114/20 | 316      | Satin    | 1.67" | 0.08"      | 20'    |
| 47-A114/20 | 316      | Polished | 1.67" | 0.08"      | 20'    |
| 49-A121/20 | 316      | Satin    | 2"    | 0.06"      | 20'    |
| 47-A121/20 | 316      | Polished | 2"    | 0.06"      | 20'    |



# Adhesive and Polish

| ITEM # | PRODUCT                      | DESCRIPTION |
|--------|------------------------------|-------------|
| 00202  | Lavi Metal Polish            | Polish      |
| 00201  | Loctite 326                  | Adhesive    |
| 00211  | Loctite 7649                 | Primer      |
| 00203  | MAAS Stainless Steel Cleaner | Cleaner     |
| 00204  | MAAS Polishing Cloth         | Cloth       |



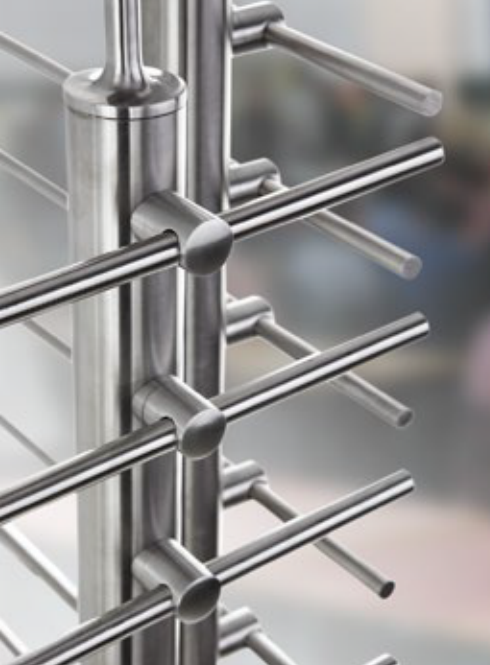

© 2020 Lavi Industries. All Rights Reserved.

Lido-Tone and GlassGrip are registered trademarks of Lavi Industries.

All product designs © Lavi Industries.

No part of this catalog may be reproduced or transmitted in any form or by any means, electronic or mechanical, including photocopying, recording, or by any information storage and retrieval system, without prior written permission from Lavi Industries.

Lavi Industries has a policy of continuous development and improvement to our product line. Specifications, data, and dimensions may change without notice. When these specifications or colors are critical, consult the factory for current information.

## **Lavi Industries** *Stainless Steel Railing Systems*

Texas Office  
5885 E. Houston Street  
San Antonio, TX 78220

California Office  
27810 Avenue Hopkins  
Valencia, CA 91355

[railings.lavi.com](http://railings.lavi.com) • [railings@lavi.com](mailto:railings@lavi.com) • 877.275.5284