

C. A. T. Prefabricated Posts

RECOMMENDED TOOLS:



15mm Wrench



Goggles



Cable Cutters



Phillips
Screwdriver

STEP 1

MOUNT ALL PREFABRICATED POSTS

Determine the location for each prefabricated End Post and Center Post. Utilizing the appropriate bolts for your substrate, anchor all posts in their respective positions. The center-to-center distance should not exceed 48".

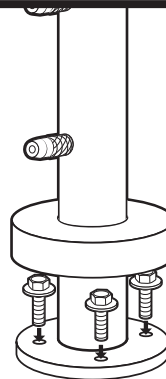

Floor Mount

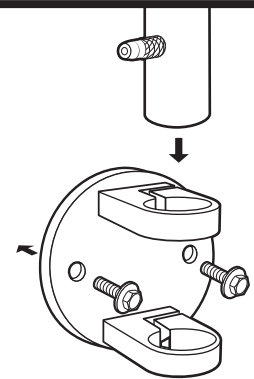

Fascia Mount

STEP 2

PREPARE THE TOP RAIL

Start by marking the top rail to indicate where to drill holes. Then drill and tap a 10-24 thread for each saddle mount hole.

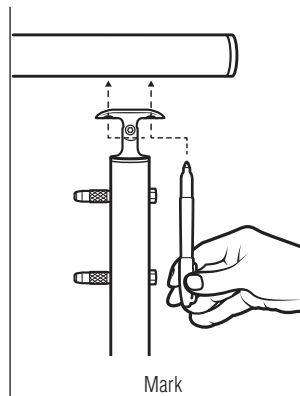

Mark

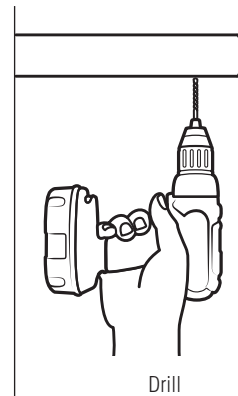

Drill

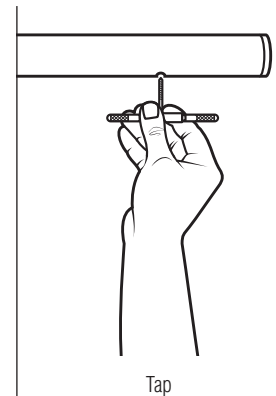

Tap

STEP 3

SECURE THE TOP RAIL

Using a Phillips screwdriver, secure the Top Rail to the Saddles using 10-24 stainless steel screws.

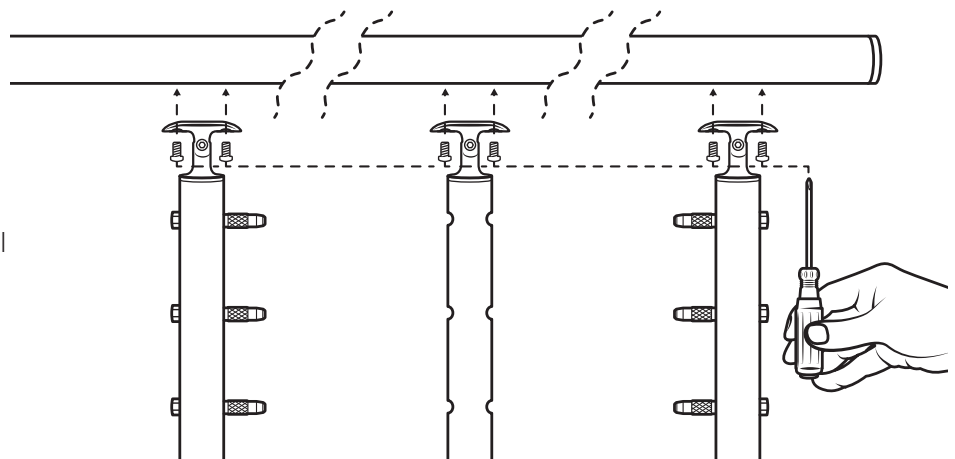

STEP 4

THREAD CABLE THROUGH POSTS

Start by threading the cable through the center post[s], then loosely pull through the end posts. Cut the cable on each end, leaving 4" length to accommodate tensioning. Repeat the process for all cables/holes. Loosen the connectors almost all the way.

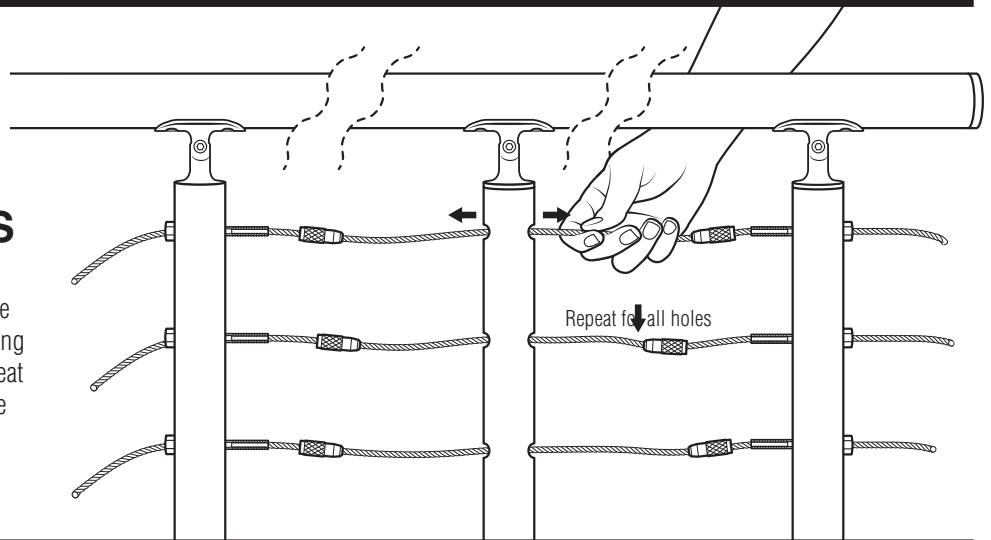

STEP 5

TENSIONING THE CABLES

Take up all slack in the cables by tightening each end post nut with the 15 mm Wrench and check the tension.

Tension the bottom cable a nominal amount and progress towards the top cable one by one.

Start the process again in the same sequence adding a little more tension to the cables.

Repeat until desired tension is obtained. The tension should be such that you don't have more than 4" gap between two cables.

Note: Do not tight one cable to the desired tension while other cables are still lose, it may damage the shape of the system.

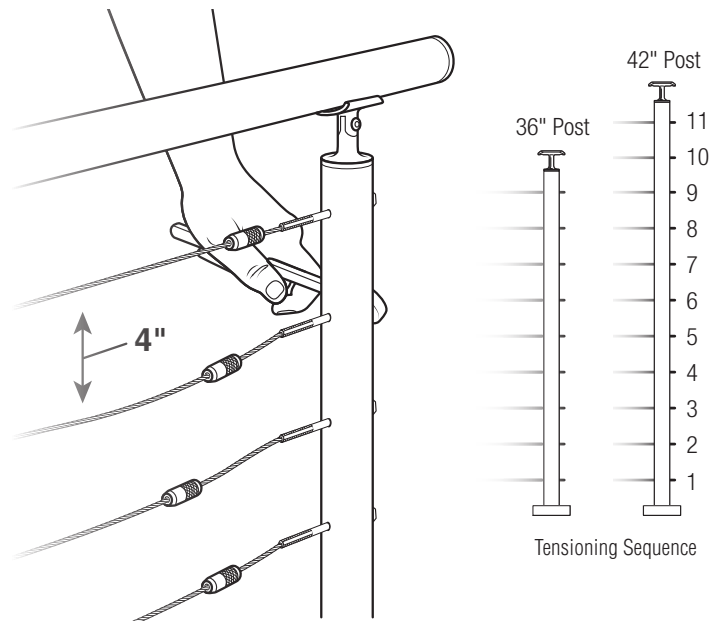

STEP 6

THE FINISHING TOUCH

Once each cable has the proper tension, remove the excess with Cable Cutters or Grinder Wheel.

Set a Cap over each End Post's tensioning nut and lightly tap in place with a Hammer.

