

GLASS RAILING

Aluminum Shoe Moulding



Wet-Glaze Aluminum Shoe Moulding

Freestanding, frameless Glass Railing Systems offer a classically modern look to your project. The traditional, wet-glaze installation method is a tried and true process that firmly secures the glass into the aluminum base shoe. Mount the shoe directly to the floor or side mount as a fascia-mount.

Add the finishing touch to your Glass Railing project by adding a Channel Tubing handrail. We offer all the necessary components to make installation a breeze.

Please see pages 26–27 for more information.



Aluminum Shoe Moulding for 1/2" Glass

Creates a clean look in Glass Railing.

ITEM #	MATERIAL	PRE-DRILLED HOLES	LENGTH
50-A123B/20	Aluminum	none	20'
50-A123B/DR/20	Aluminum	yes	20'
50-A123B/CB/20	Aluminum	counter-bored	20'

Use with A114U Channel Tube and 85-CTI Rubber Insert. See Page 26.

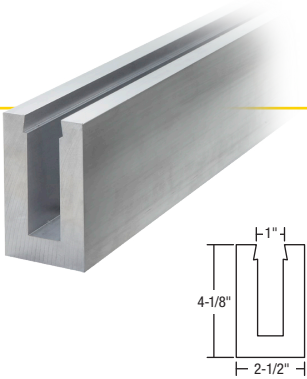

Pre-drilled Hole Sizes

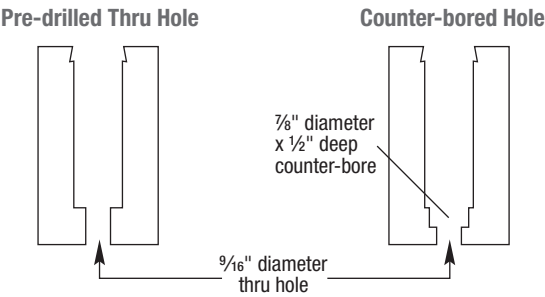

Pre-drilled Hole Locations

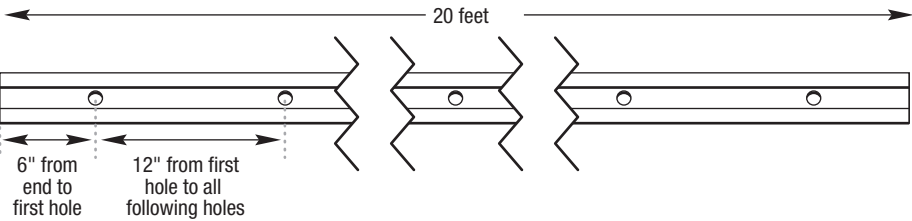

Solid Stainless Steel Cladding

Creates a finished look for the mill-finish aluminum shoe.

ITEM #	MATERIAL	FINISH	LENGTH
47-CLD04/10	316 Stainless Steel	Polished	10'
49-CLD04/10	316 Stainless Steel	Satin	10'

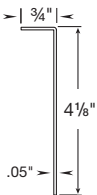

Glass Railing Assembly

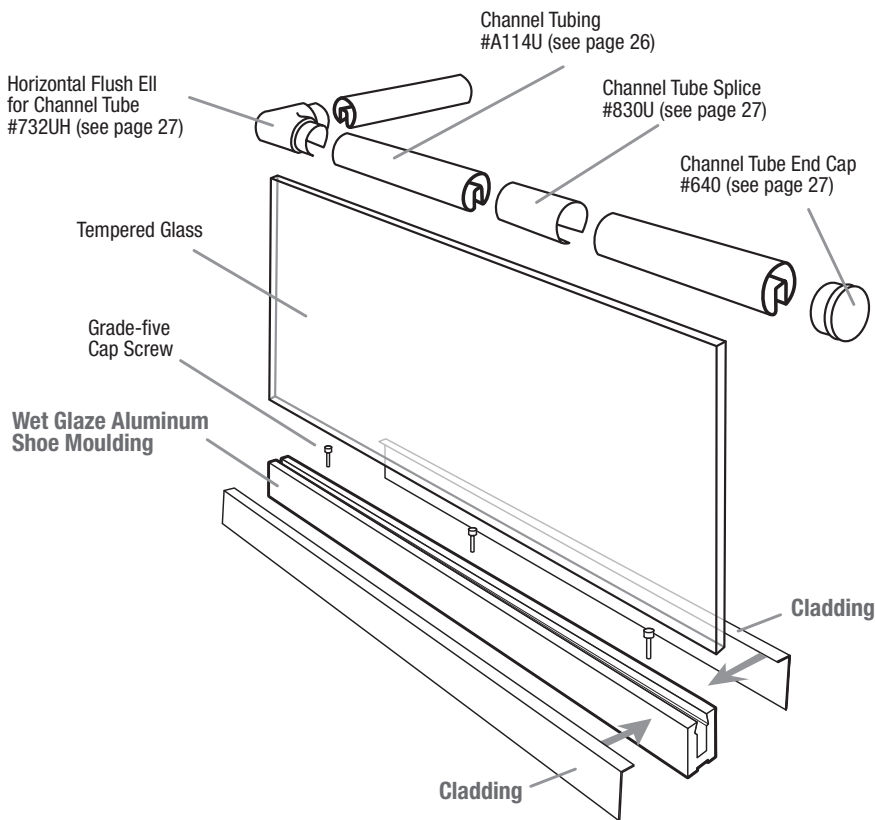

Mounting Conditions

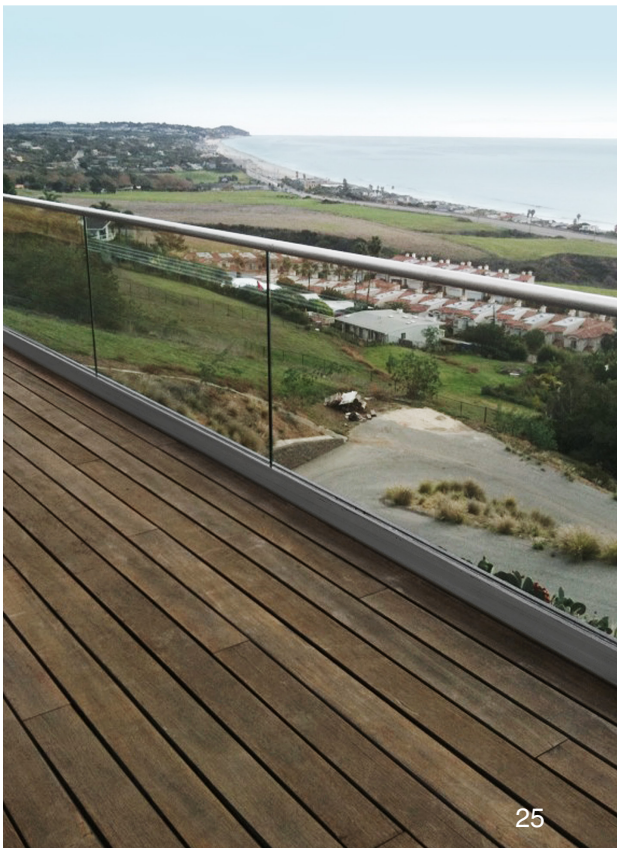
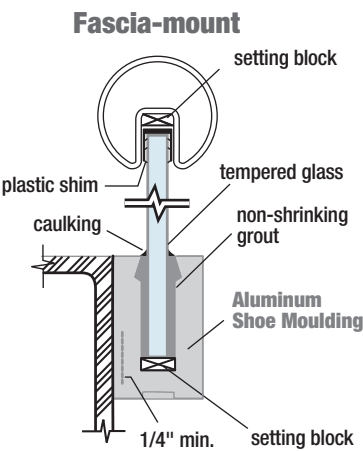
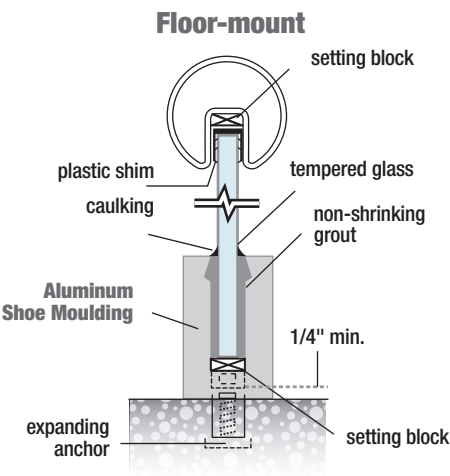

Channel Tubing

Glass railing offers a clean, elegant and open solution for any environment.

Channel tubing is used to cap the top of the glass panel and gives the railing a finished look.

Channel Tube

Used to finish the top of glass railing.

ITEM #	MATERIAL	FINISH	OD	WALL THICK	LENGTH	W	D
44-A114U/16	304	Satin	1.67"	0.06"	16'	0.94"	0.94"
40-A114U/16	304	Polished	1.67"	0.06"	16'	0.94"	0.94"
49-A114U/16	316	Satin	1.67"	0.06"	16'	0.94"	0.94"
47-A114U/16	316	Polished	1.67"	0.06"	16'	0.94"	0.94"

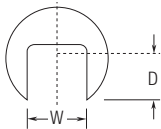

Channel Tube Insert

Used to secure glass inside a Channel Tube.

ITEM #	MATERIAL	GLASS THICK	LENGTH
85-CTI1002	Rubber	1/2"	100'
85-CTI1003	Rubber	3/4"	100'

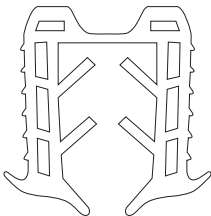

Channel Tube Fittings

Horizontal Flush Ell for Channel Tube

Connects channel tube in 90° angle horizontally.

ITEM #	MATERIAL	FINISH	TUBE	WALL THICK	W	L
49-732UH/424	316	Satin	1.67	0.06"	2.03"	2.03"
47-732UH/424	316	Polished	1.67	0.06"	2.03"	2.03"

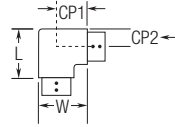

Vertical Flush Ell for Channel Tube

Connects channel tube in 90° angle vertically.

ITEM #	MATERIAL	FINISH	TUBE	WALL THICK	W	L
49-732UV/424	316	Satin	1.67	0.06"	1.97"	1.97"
47-732UV/424	316	Polished	1.67	0.06"	1.97"	1.97"

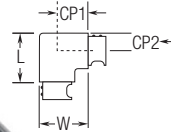

Channel Tube Splice

Connects channel tube in a straight line.

ITEM #	MATERIAL	FINISH	TUBE	WALL THICK	W
49-830U/424	316	Satin	1.67"	.06"	0.24"
47-830U/424	316	Polished	1.67"	.06"	0.24"

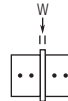

Channel Tube End Cap

Closes the end of a channel tube.

ITEM #	MATERIAL	FINISH	TUBE	WALL THICK	D	H
49-640/424	316	Satin	1.67"	.06"	1.67"	0.16"
47-640/424	316	Polished	1.67"	.06"	1.67"	0.16"

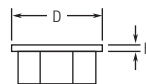

Specially designed to fit with glass channel tube, these fittings add a design dimension to the standard linear aspect of glass railing. In addition to the tight fit, each fitting has threaded screw bosses for a more secure connection.

