

Tri-Base

Parts List:

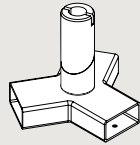

(1) Allen Wrench



(1) Tri-Hub center piece
with Wedge Insert

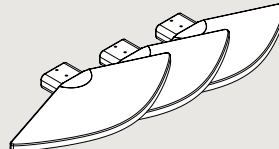

(3) Half Moon Base



(6) PFH Screws

Required Tools



Goggles



Phillips Screw Driver

1. Turn the Tri-Hub Center Piece with Wedge Insert upside down. Insert one Half Moon Base. See Figure A.
2. Insert and secure two PFH screws. See Figure B.
3. Insert the remaining two Half Moon Bases into the Tri-Hub Center Piece and secure them with PFH Screws.
4. Flip the fully-assembled Tri-Base so that the Wedge Insert is facing up. The Tri-Base is now ready to receive the post. See Figure C.
5. Slide the Post over the Wedge Insert and secure with Allen Wrench. See Figure D.

