

**PART# 602/1**

Half Ball End Cap for 1" Diameter Tubing

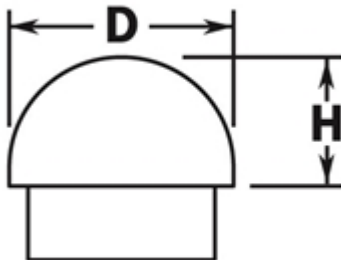

<b>D</b>	1"
<b>H</b>	1/2"

MATERIAL & AVAILABLE FINISHES			
	BRASS	304 SST	316 SST
Polished	√		
Satin	√		
Clear Coat	√		

MATERIAL USAGE			
	BRASS	304 SST	316 SST
Indoor	√		
Outdoor	√*		
*Uncoated brass only			

MATERIAL CARE	
<b>Brass</b>	Use Lavi Metal Polish (Item# 00202) and apply with a damp, soft cloth.

<b>INSTALLATION</b>	Designed to mate with 1" OD x 0.05" wall tube. Adhere fitting to tube using Loctite 326 Metal Adhesive (#00201) and Primer (#00211).
<b>HARDWARE INCLUDED</b>	---
<b>USE TOGETHER WITH</b>	1" OD x 0.05" wall tube (A100).