

PART# 820/2

Adjustable Saddle for 2" Diameter Tubing

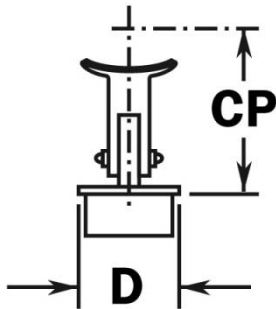

CP	3-1/8"
D	2"

MATERIAL & AVAILABLE FINISHES			
	BRASS	304 SST	316 SST
Polished	√		
Satin	√		
Clear Coat	√		

MATERIAL USAGE			
	BRASS	304 SST	316 SST
Indoor	√		
Outdoor	√*		

*Uncoated brass only

MATERIAL CARE	
Brass	Use Lavi Metal Polish (Item# 00202) and apply with a damp, soft cloth.

INSTALLATION	Place bottom of fitting in vertical tube. Screw top of bracket to horizontal tube.
HARDWARE INCLUDED	2 x #8 x 5/8" Philips pan head self drilling screws.
USE TOGETHER WITH	2" OD tube (A120), matching flush fittings for 2" tube (730/2 series) and matching finials (600/2, 602/2, 608/2).